

These drawings and specifications are the property of H2W Technologies, Inc. They are issued in confidence and shall not be reproduced, copied, or used without written permission from H2W Technologies, Inc.

REVISION TABLE					
REV	ECN#	DESCRIPTION	REV BY	APPROVED	DATE
---	---	Original Drawing	OOG	MPW	4-15-13

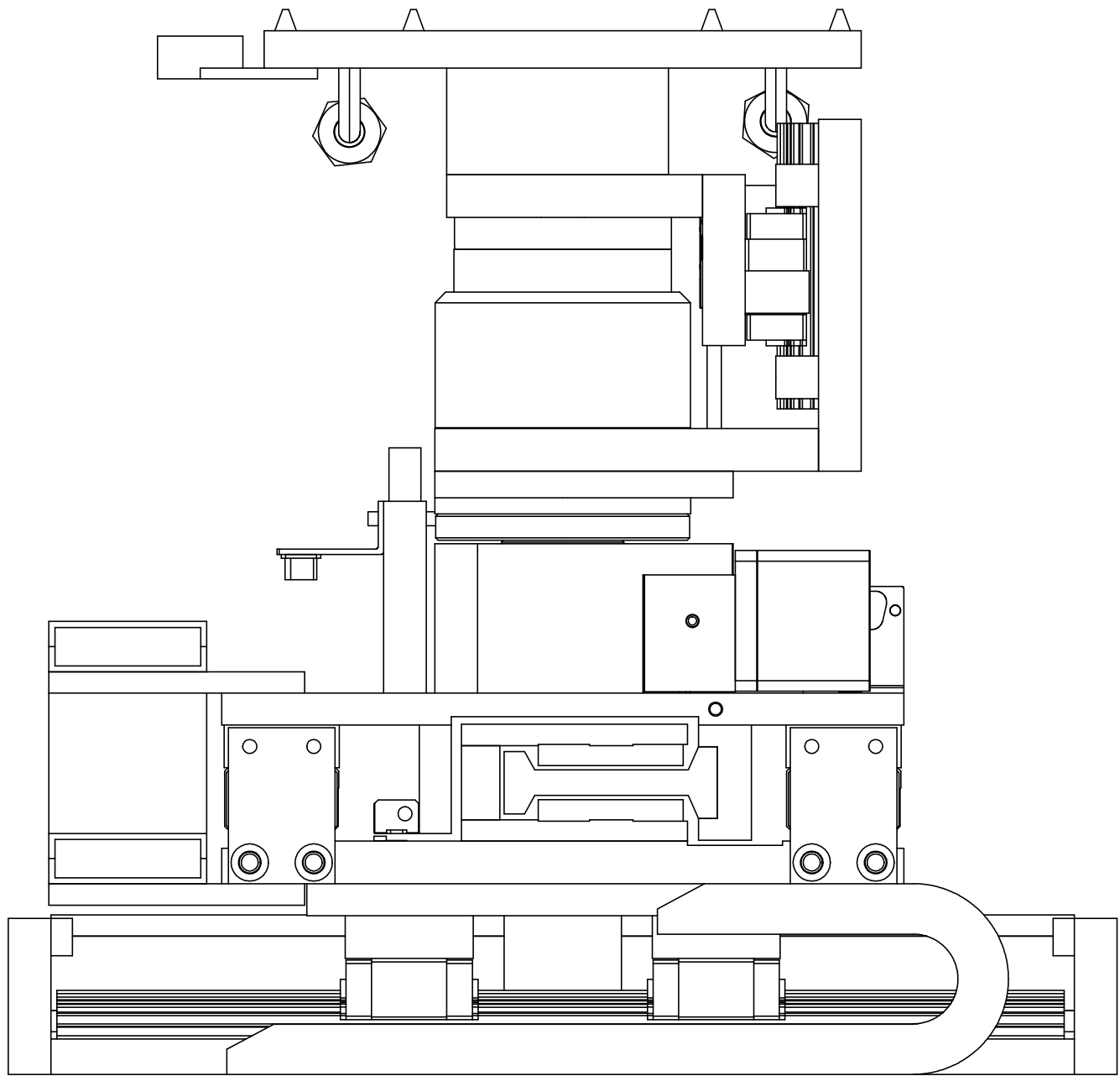
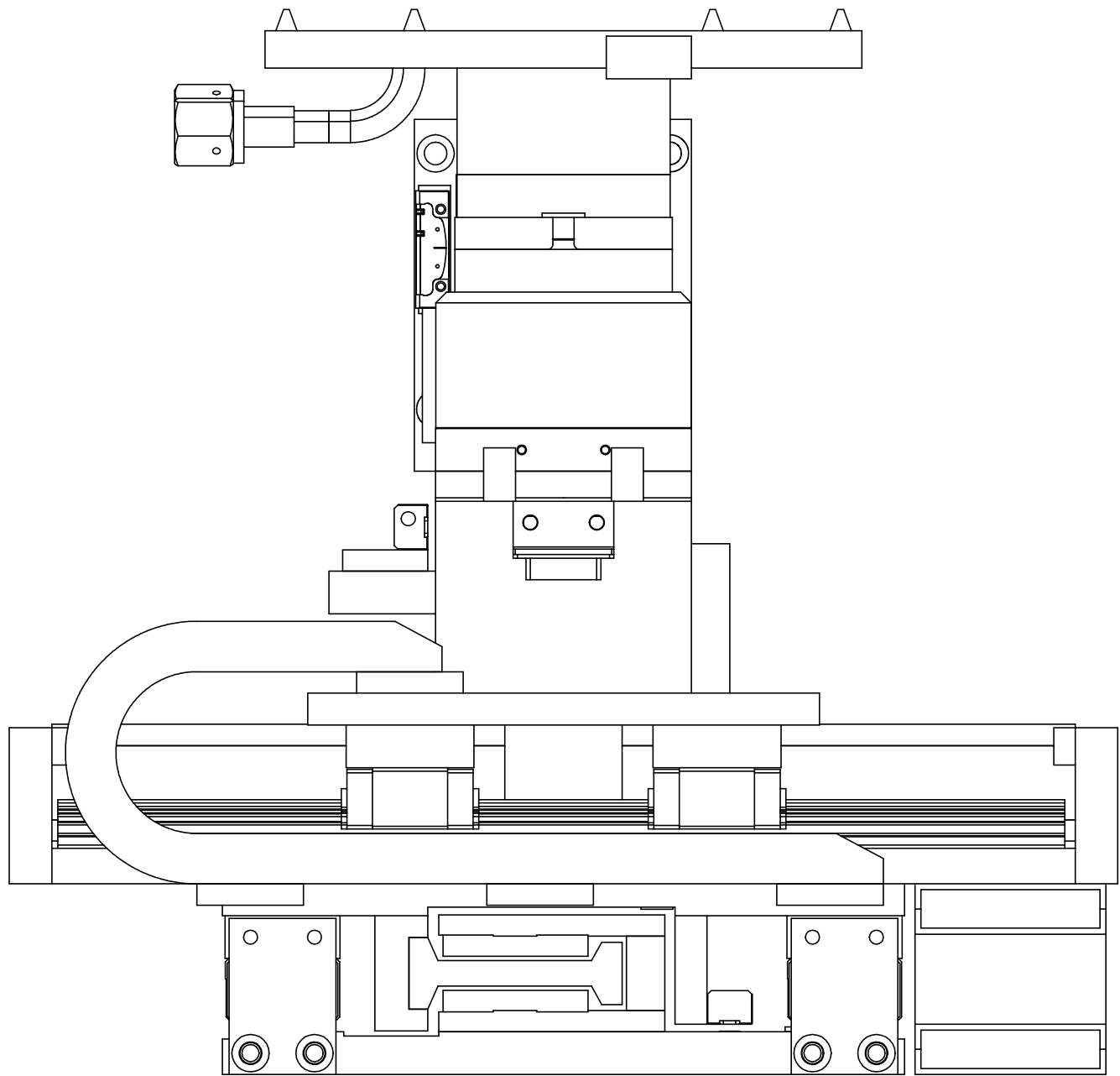
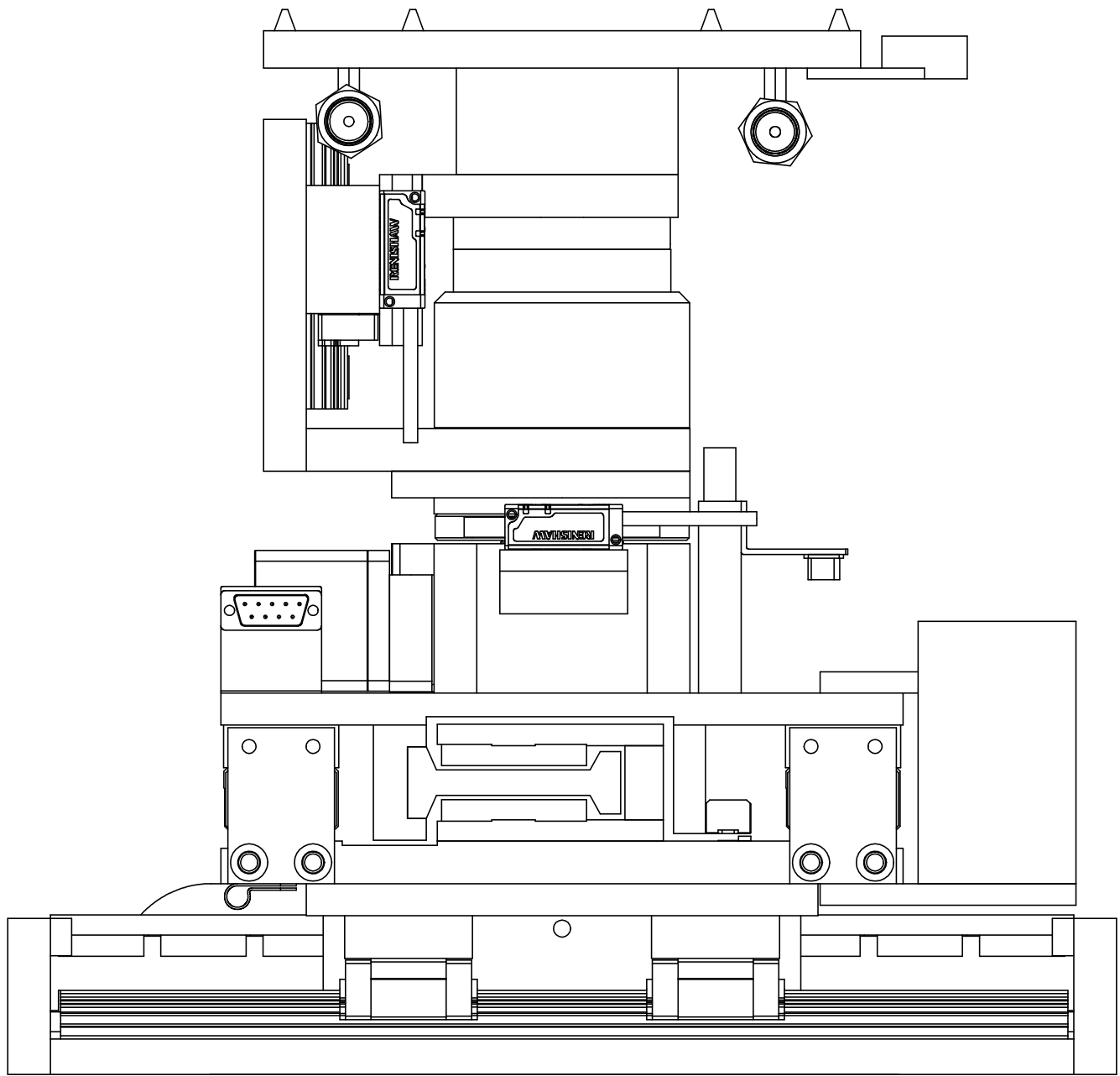
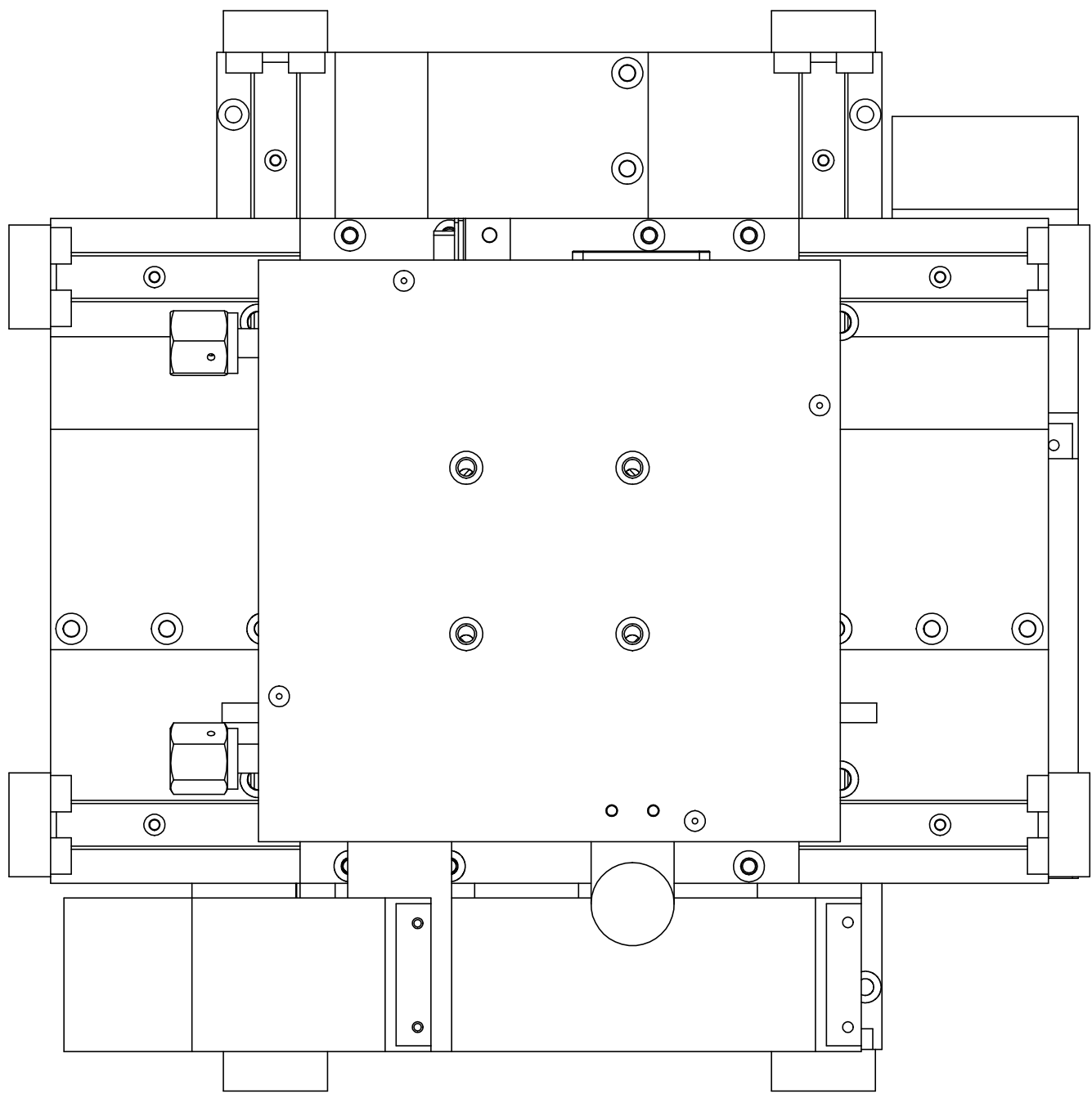

- NOTES:
1. System is shown with customer supplied Substrate Holder
 2. All axis shown at mid-stroke
 3. All parts will be bare aluminum for vacuum compatibility. No anodize will be added to parts. Color shown on drawing is for illustration purposes

				<div>H2W Technologies, Inc.</div> <div>26470 Rafter Ave #102 Santa Clara, CA 95050 USA</div> <div>Tel: (661) 251-2883 Fax: (661) 251-2867</div> <div>www.h2wtech.com</div>			
UNLESS SPECIFIED OTHERWISE: All dimensions are in inches unless specified otherwise. XXX - 3.00 XX - 0.010 X - 0.001 Remove All Burrs and Sharp Edges	MATERIAL	Aluminum 6061-T6		TITLE			
	FINISH	NONE		XYZ Theta Gantry (Vacuum Compatible)			
	DRAWN	DATE	APPROVED	DATE	DWG#	REV	SHEET
	OOG	4-15-13	MPW	4-15-13	47-0040	A	1 of 5

These drawings and specifications are the property of H2W Technologies, Inc. They are to be used in confidence and shall not be reproduced, copied, or used without written permission from H2W Technologies, Inc.

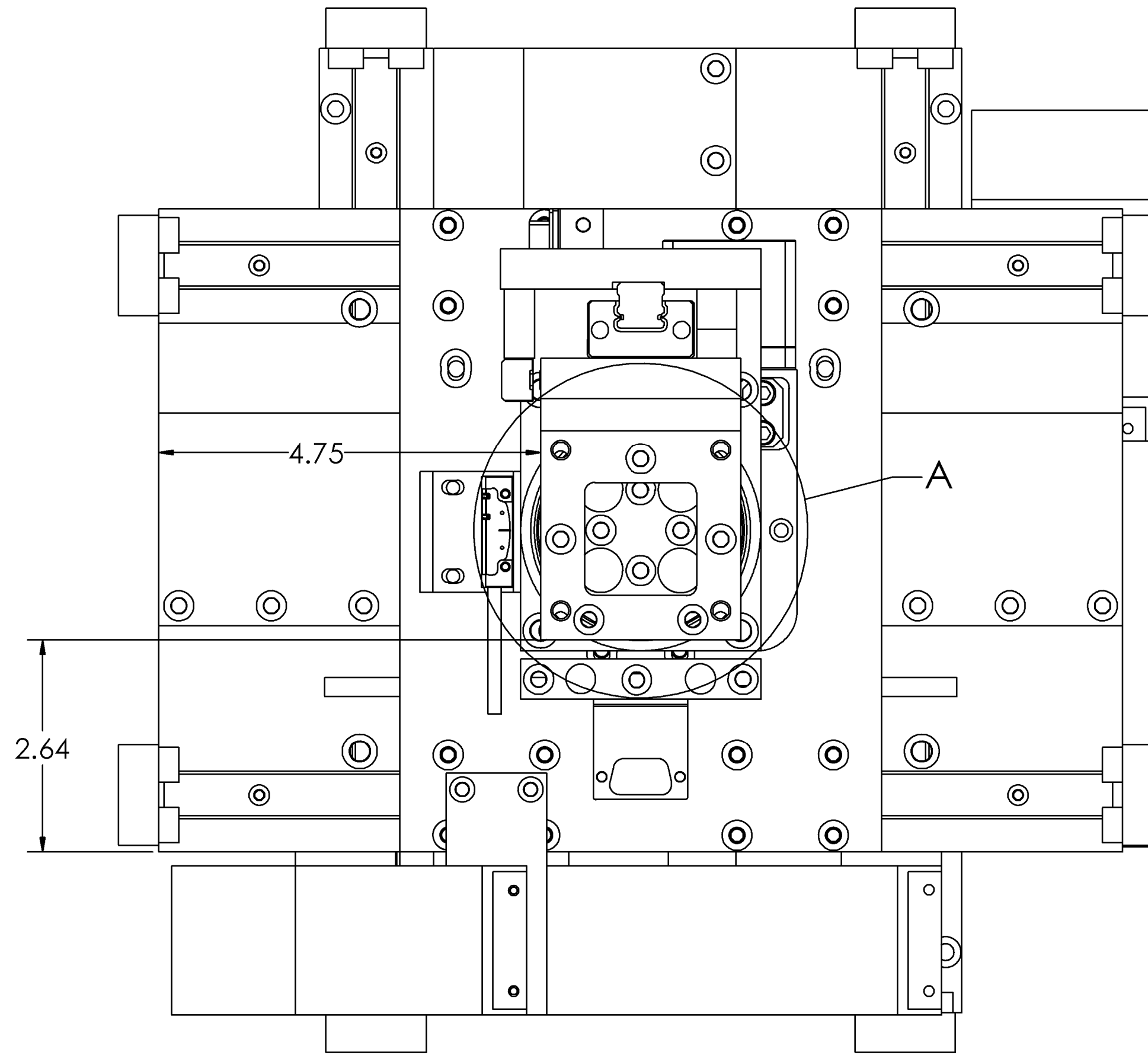
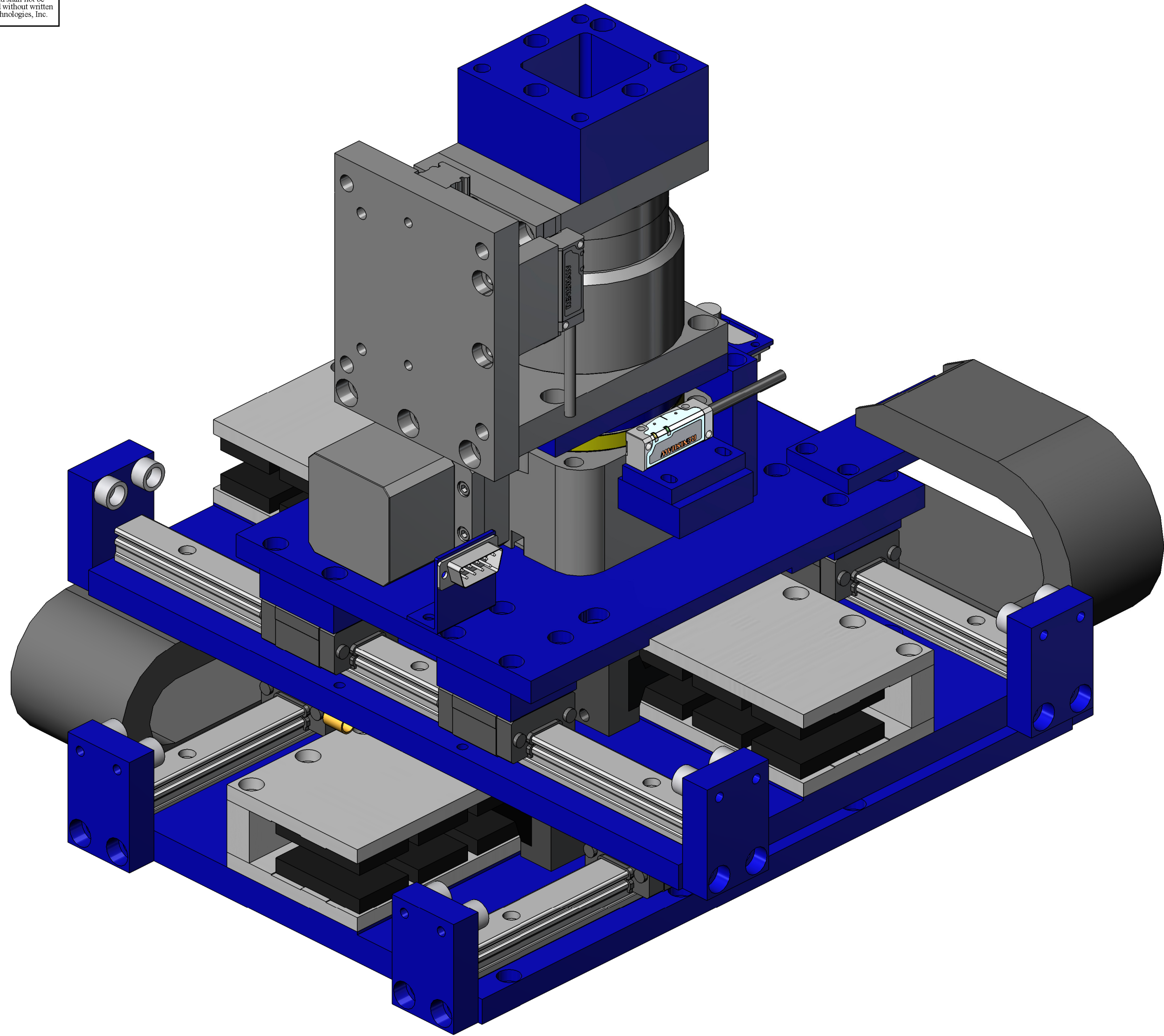

SUBSTRATE MOUNTING
Parts have been hidden to show mounting holes

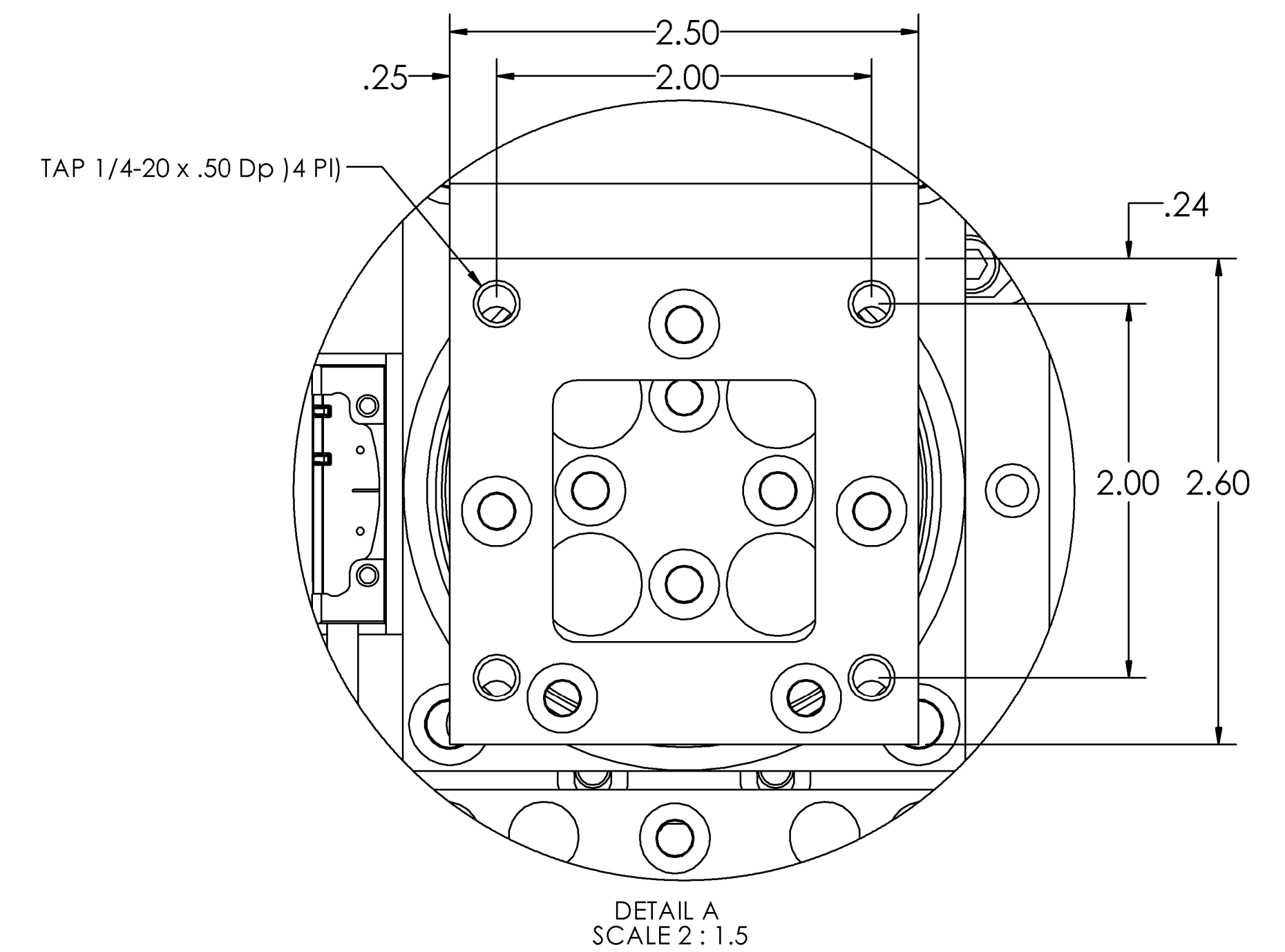

STAGE MOUNTING
Parts have been hidden to show mounting holes

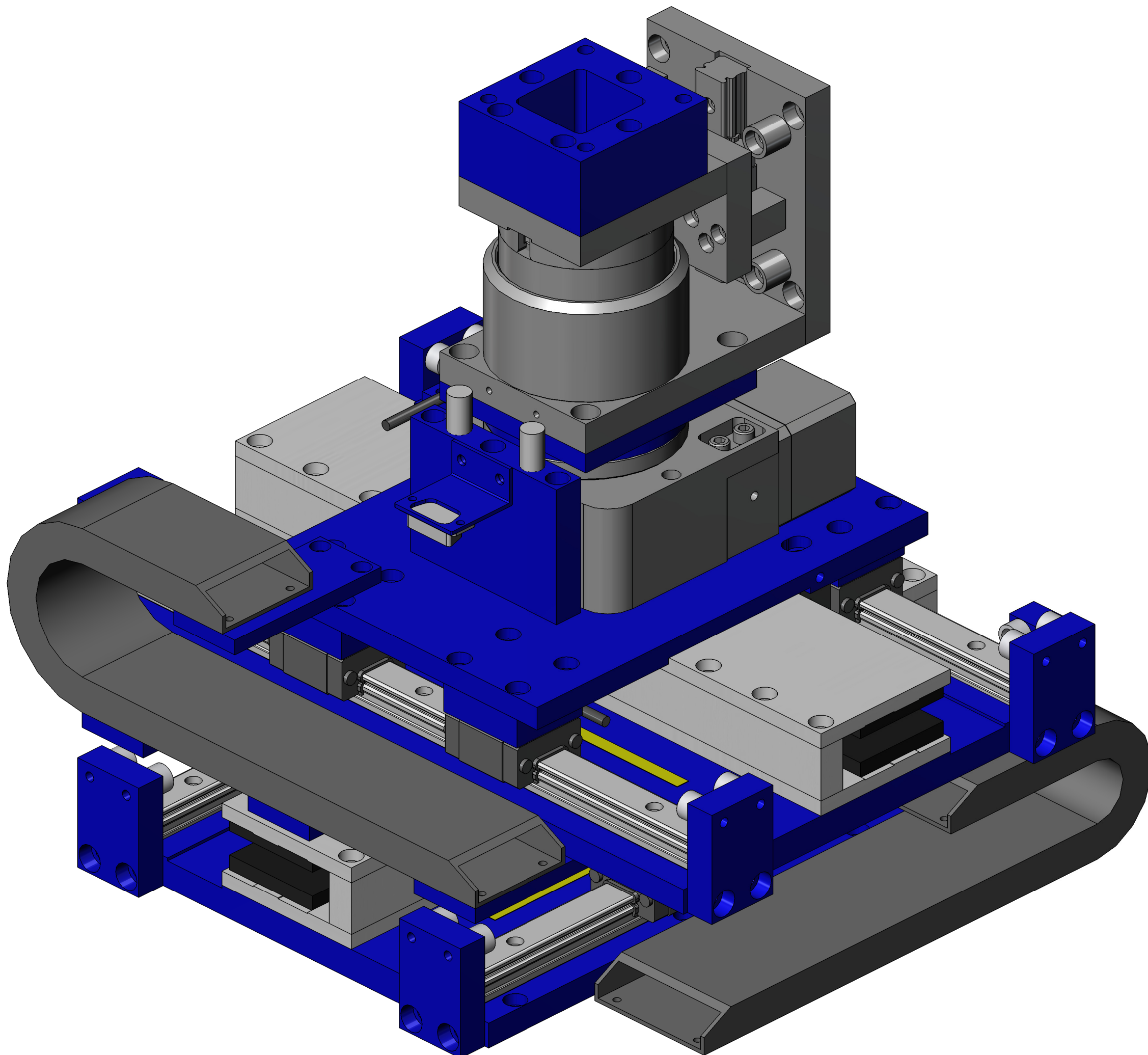
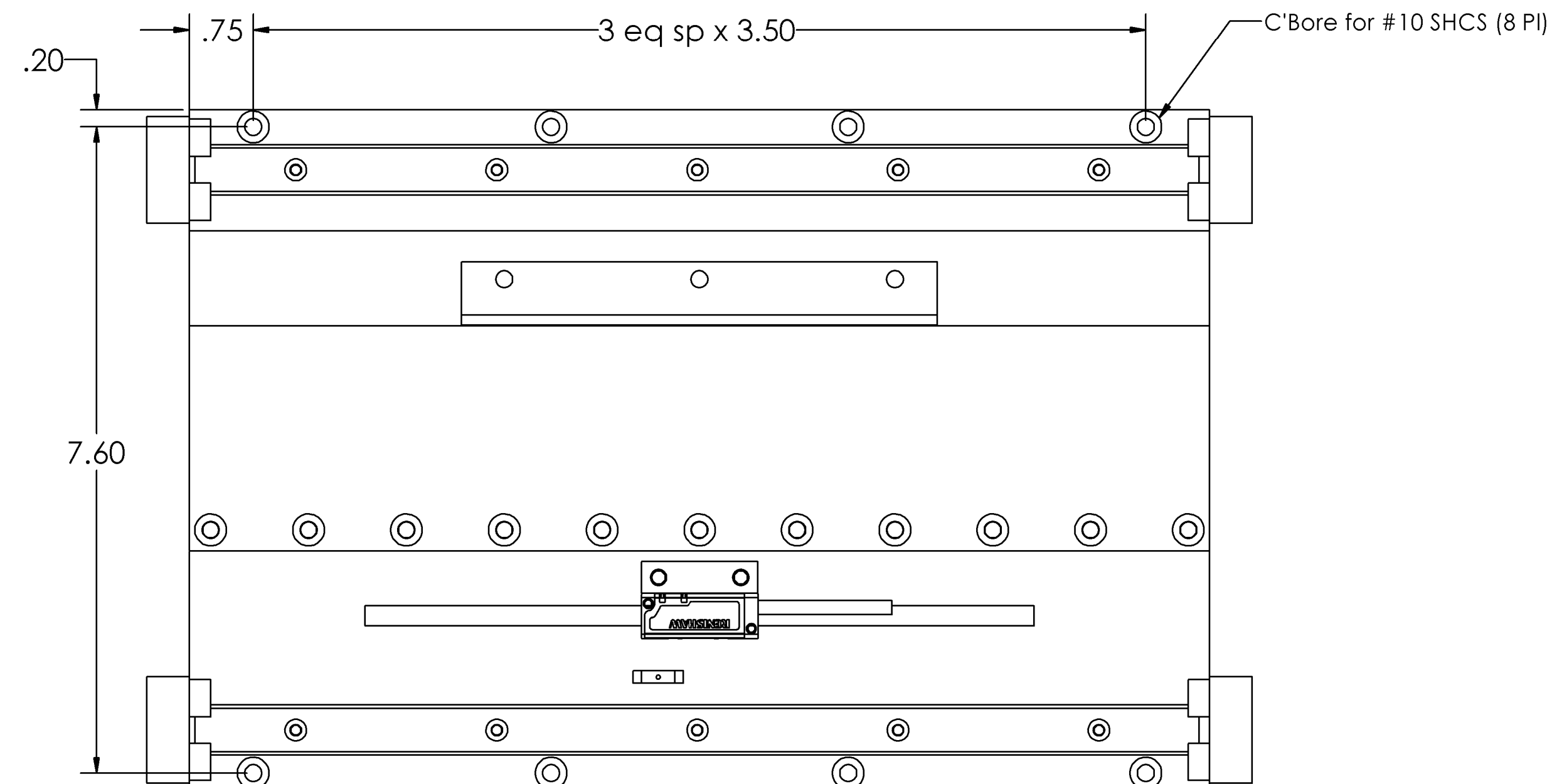

These drawings and specifications are the property of H2W Technologies, Inc. They are intended in confidence and shall not be reproduced, copied, or used without written permission from H2W Technologies, Inc.

ROTARY DISPLACEMENT

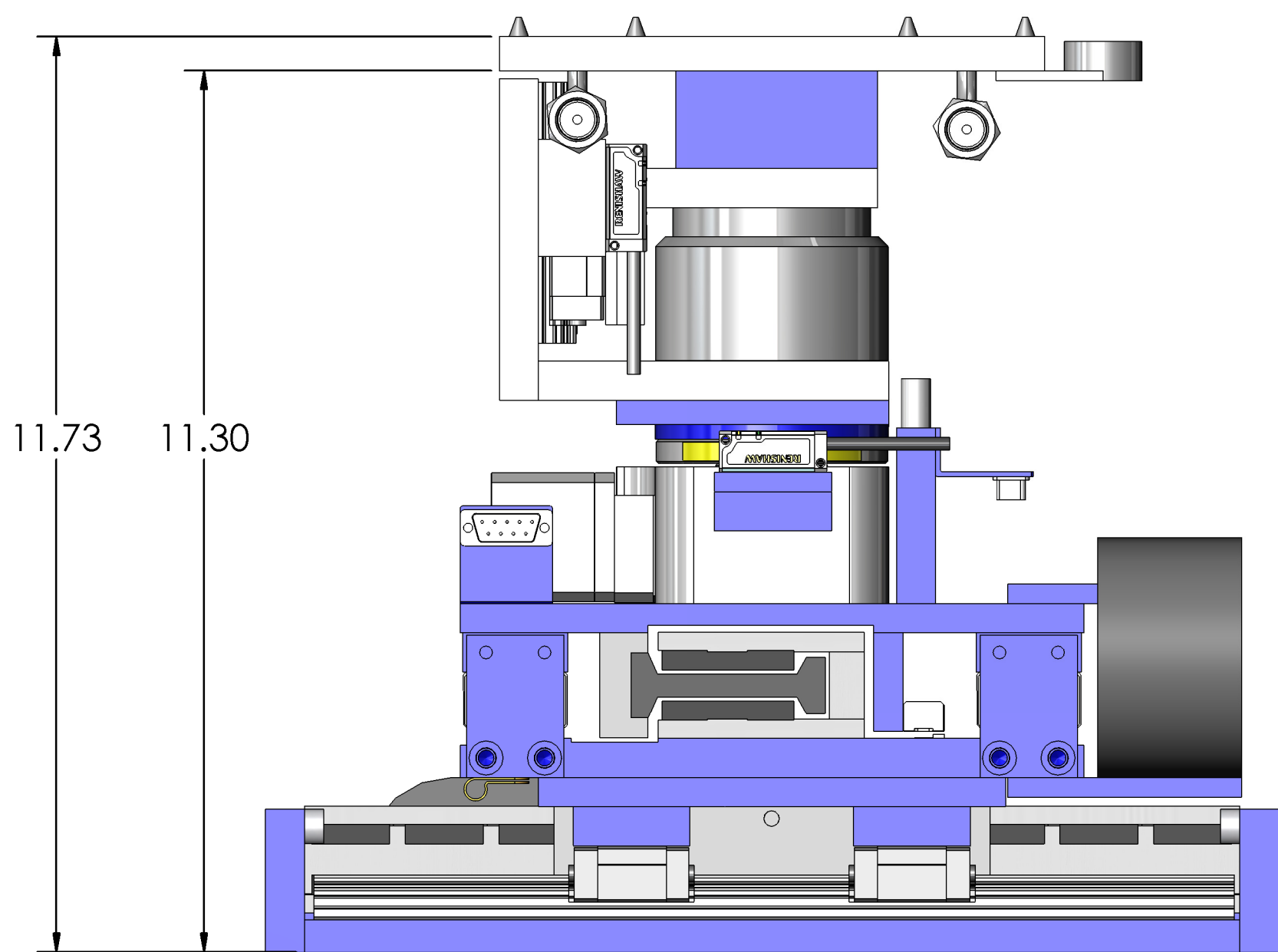
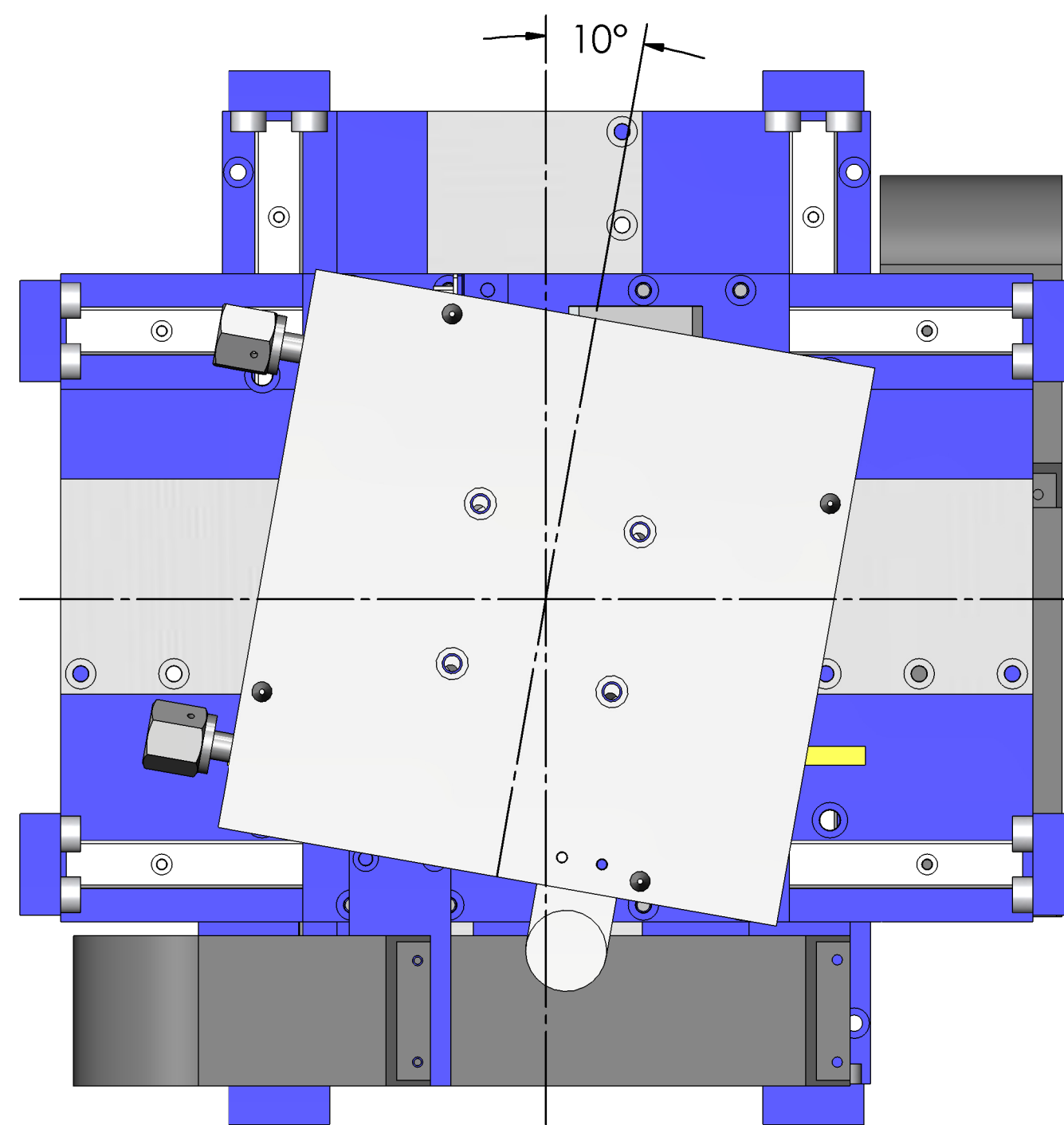
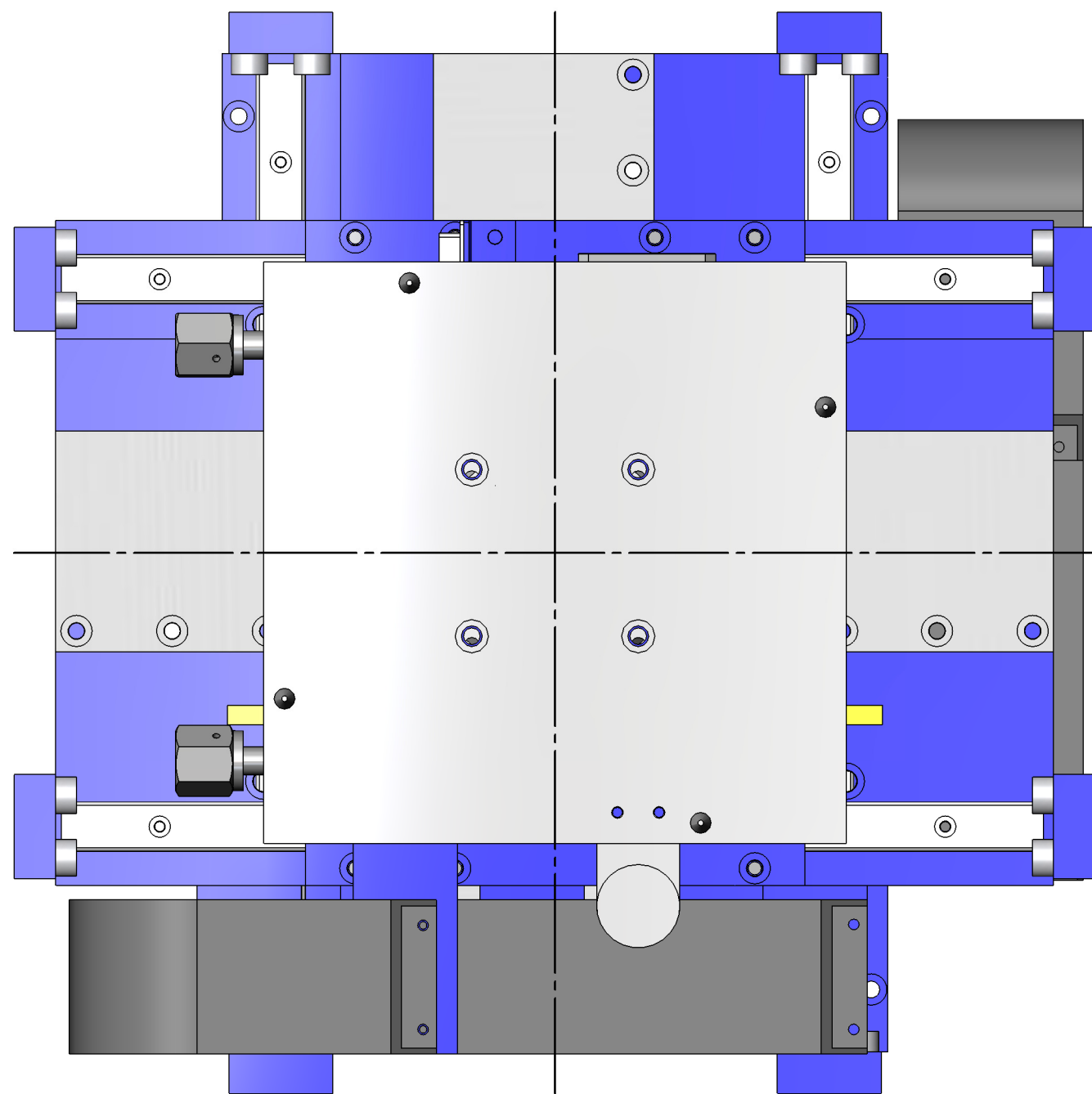
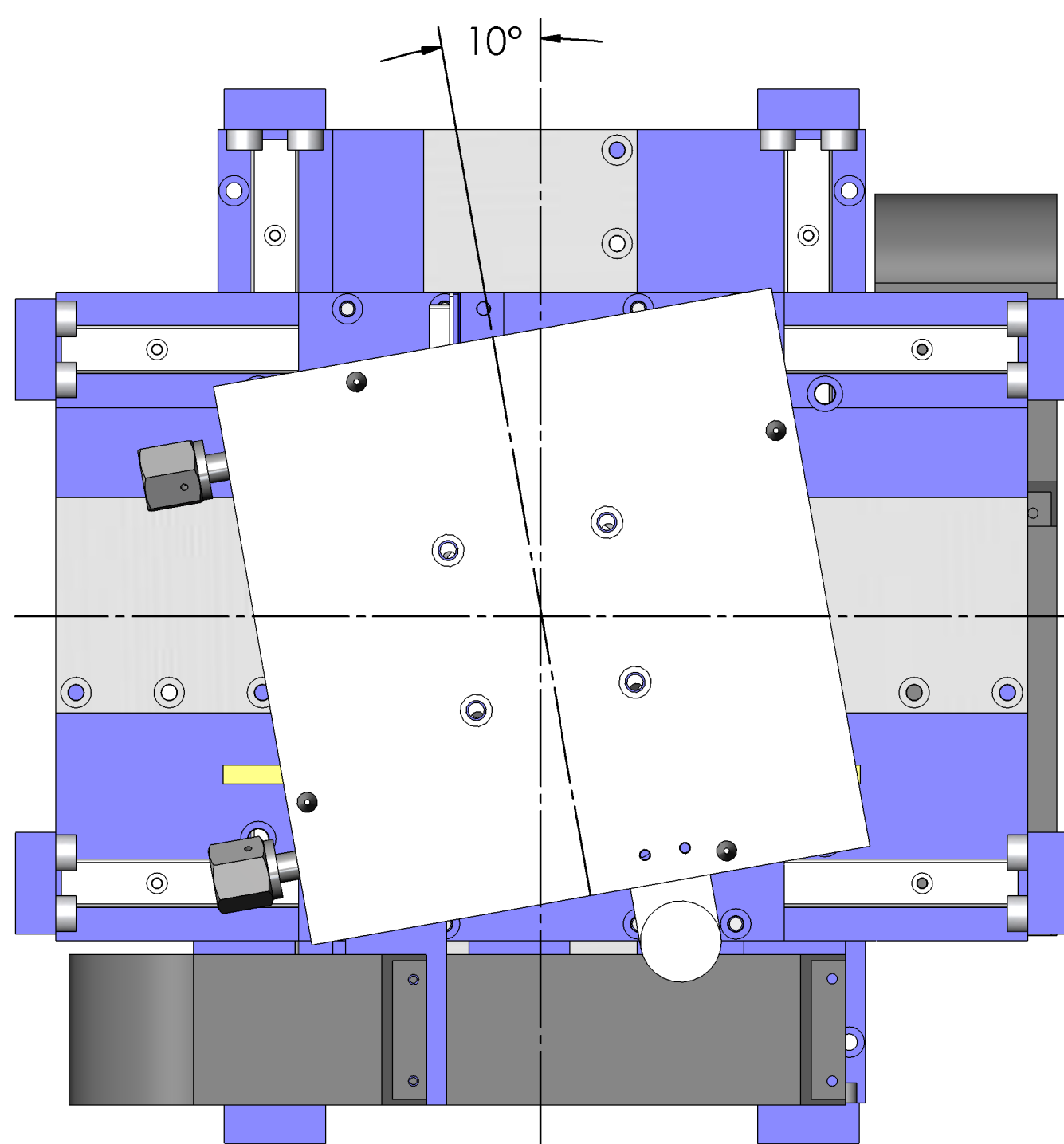

RETRACTED

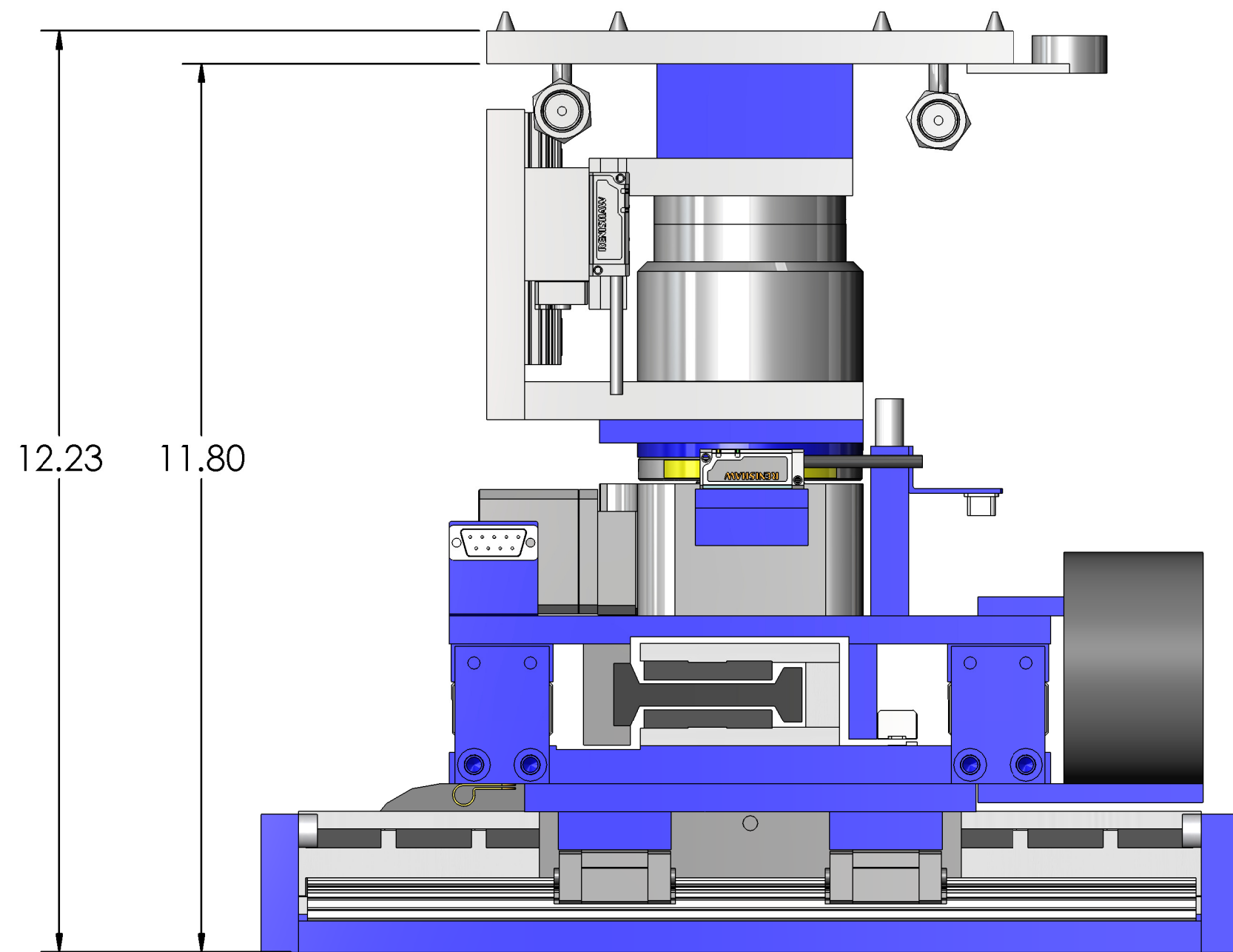

CENTERED

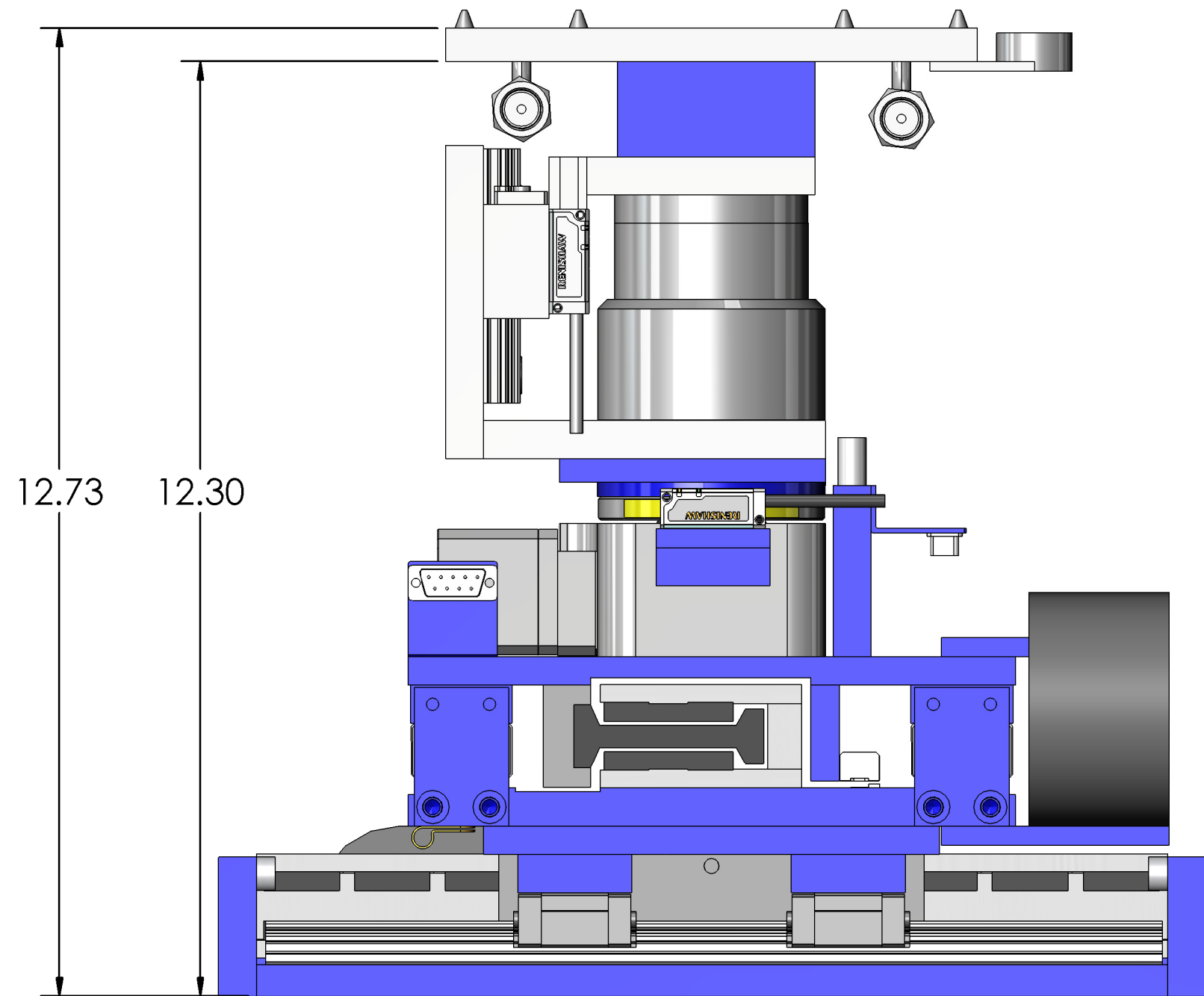

EXTENDED

STAGE HEIGHT

NOTES:
1. System is shown with customer supplied Substrate Holder

TOP AXIS

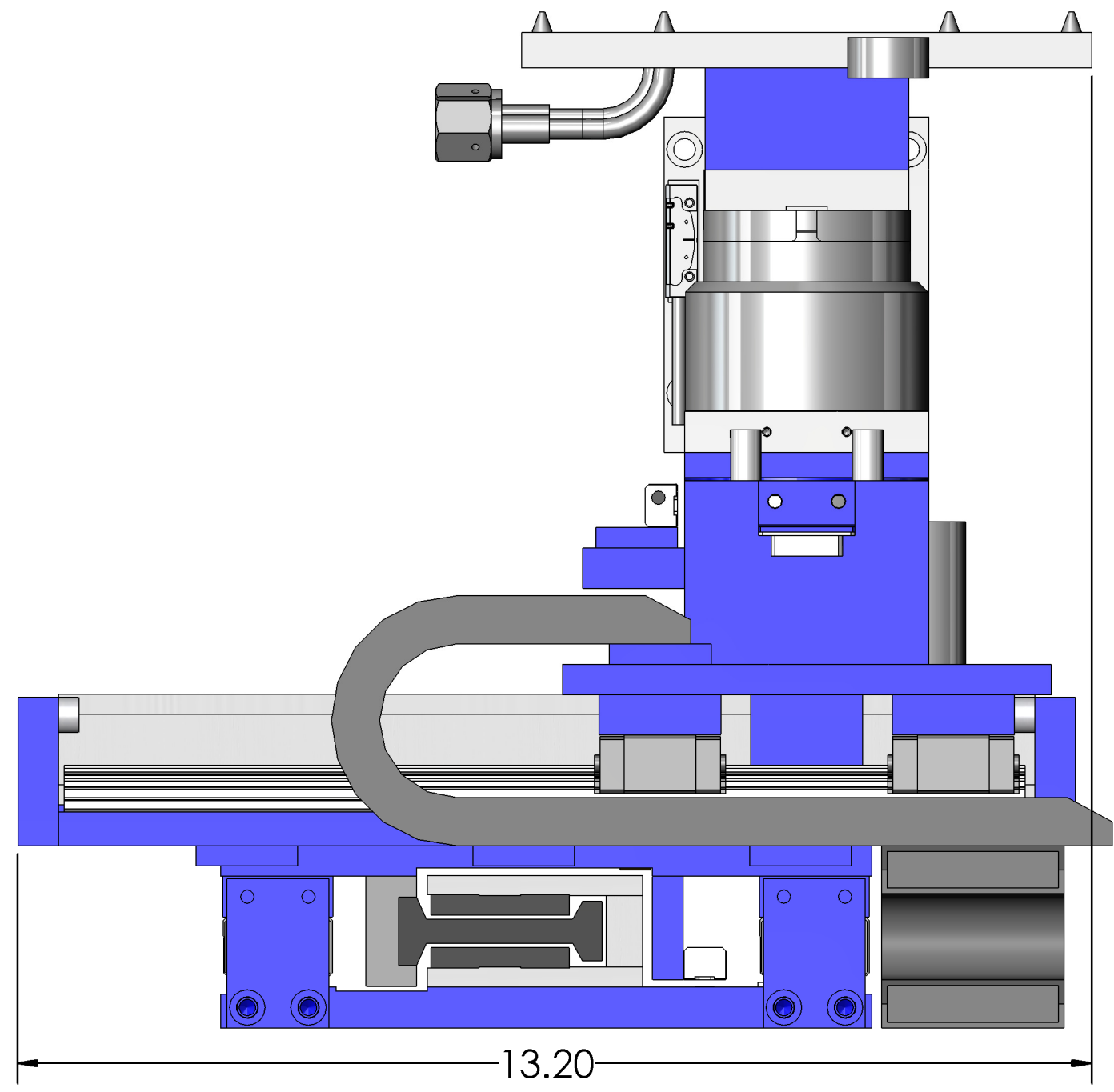
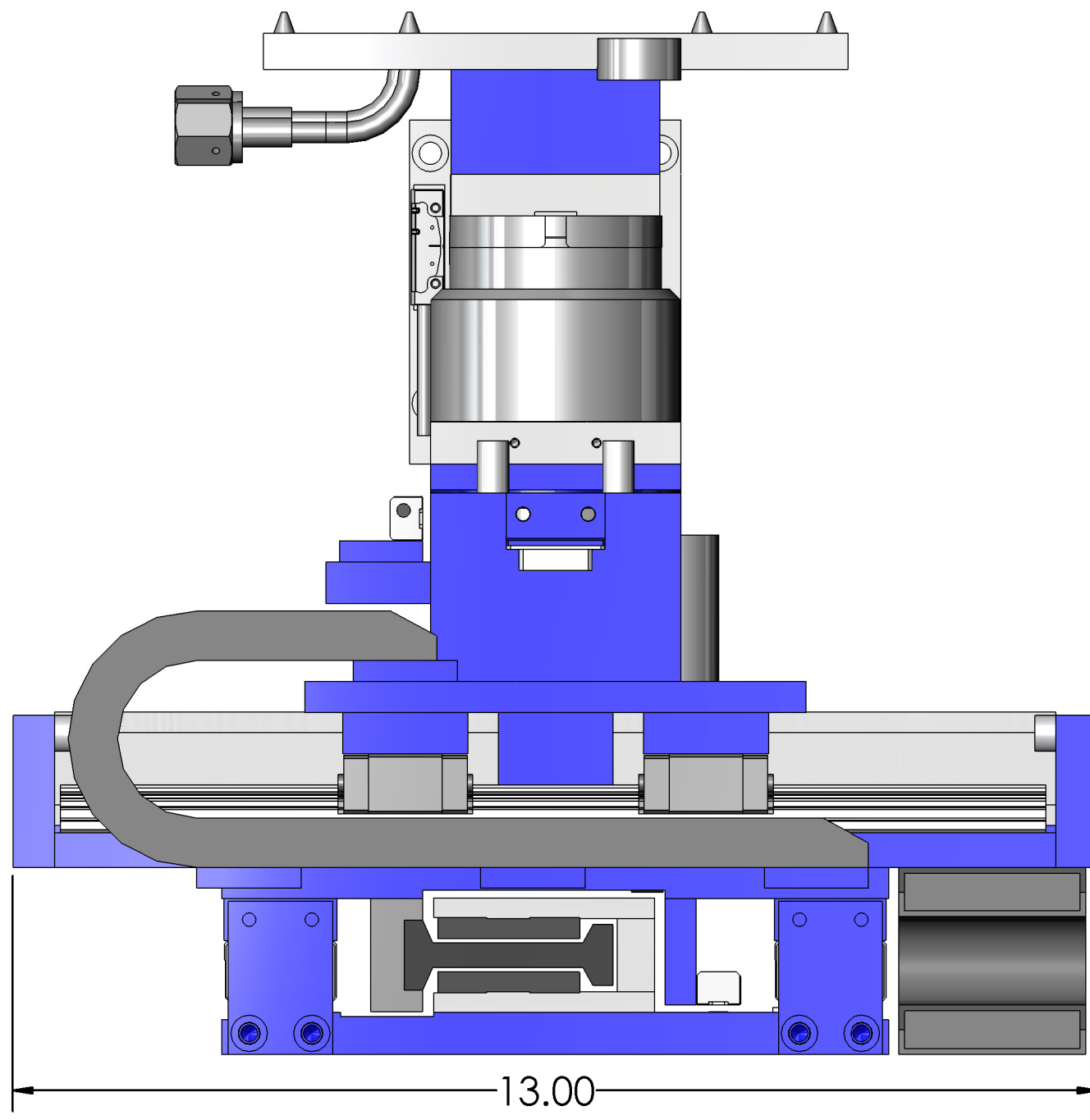
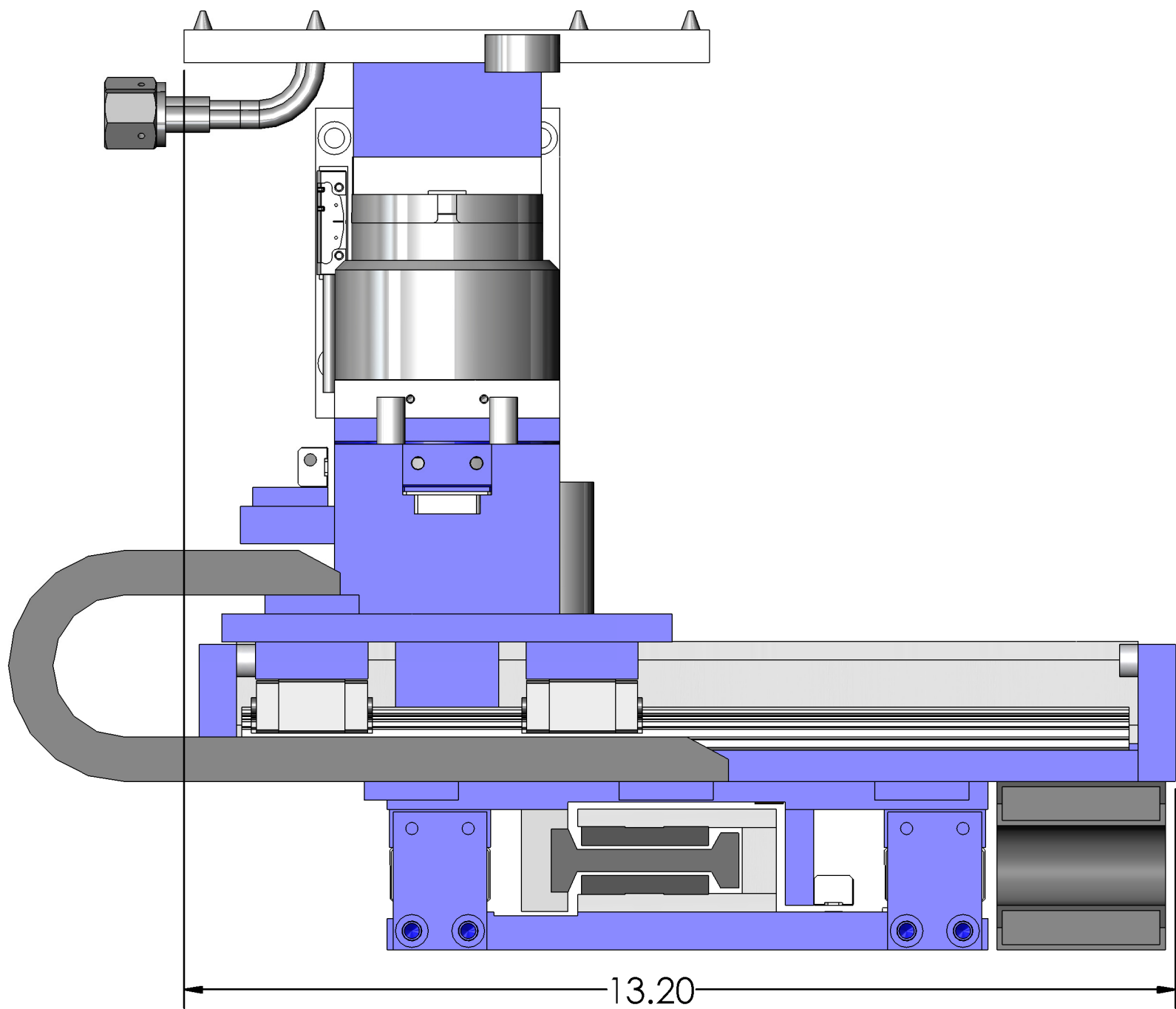

EXTENDED

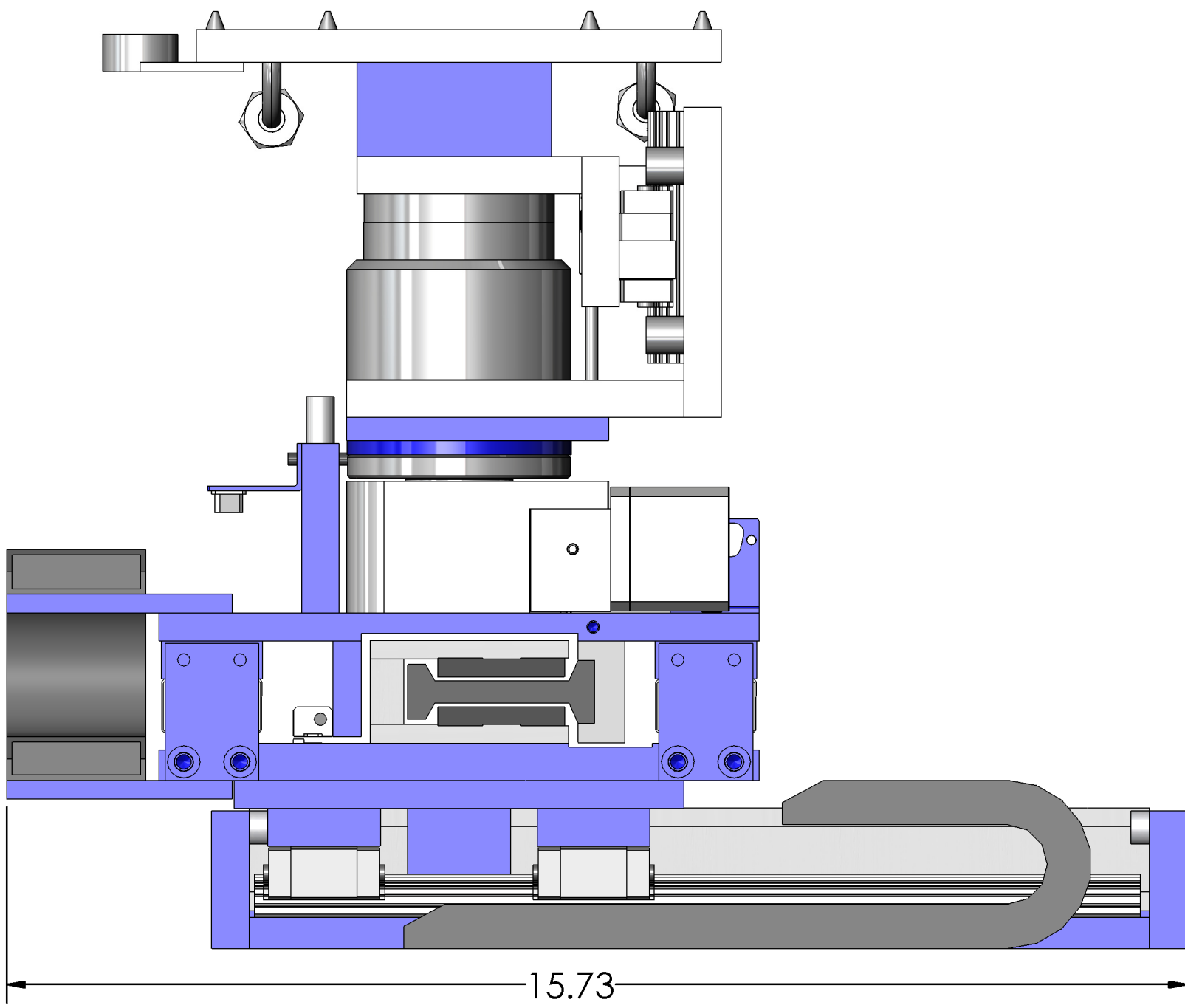

CENTERED

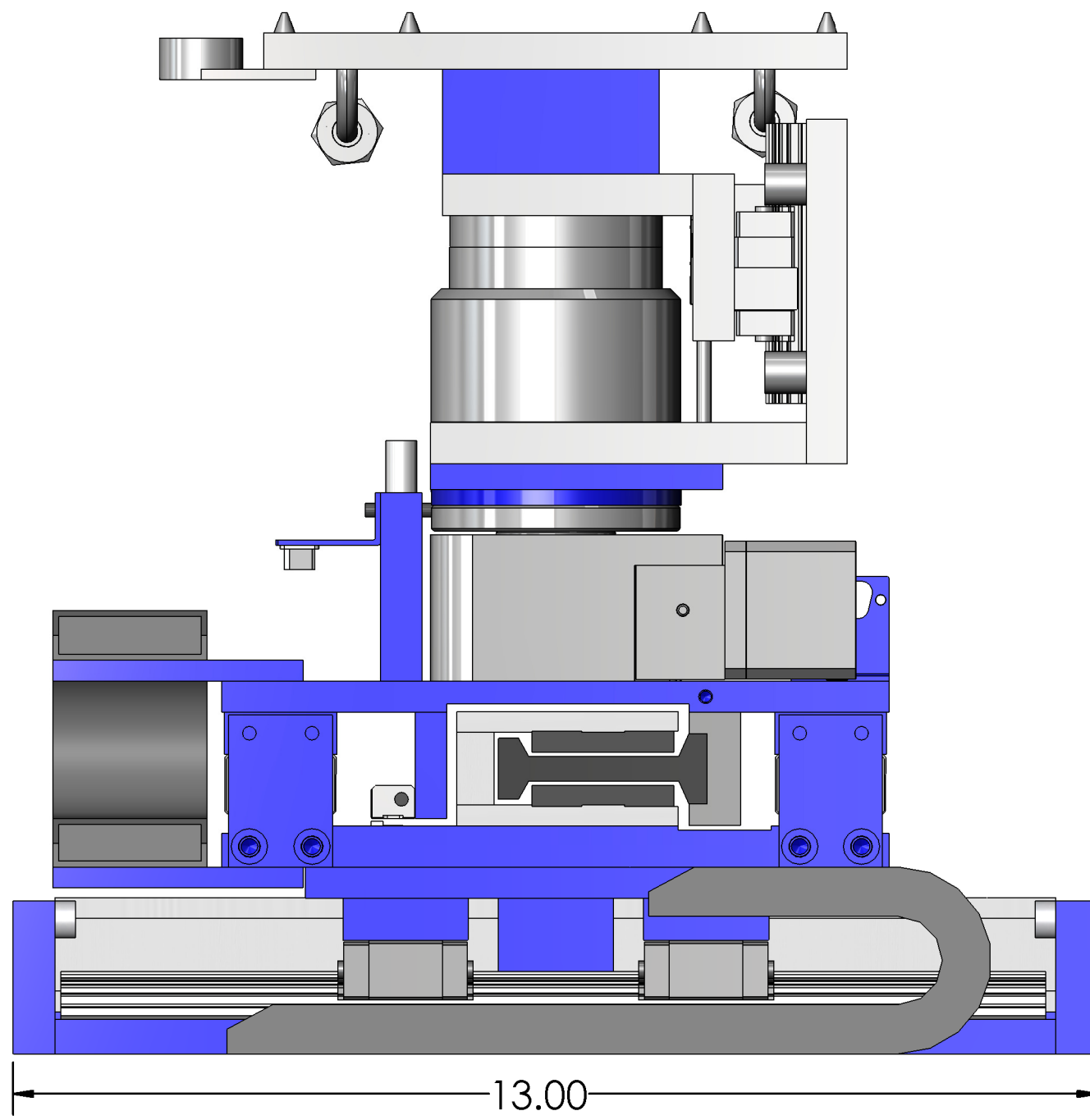

RETRACTED

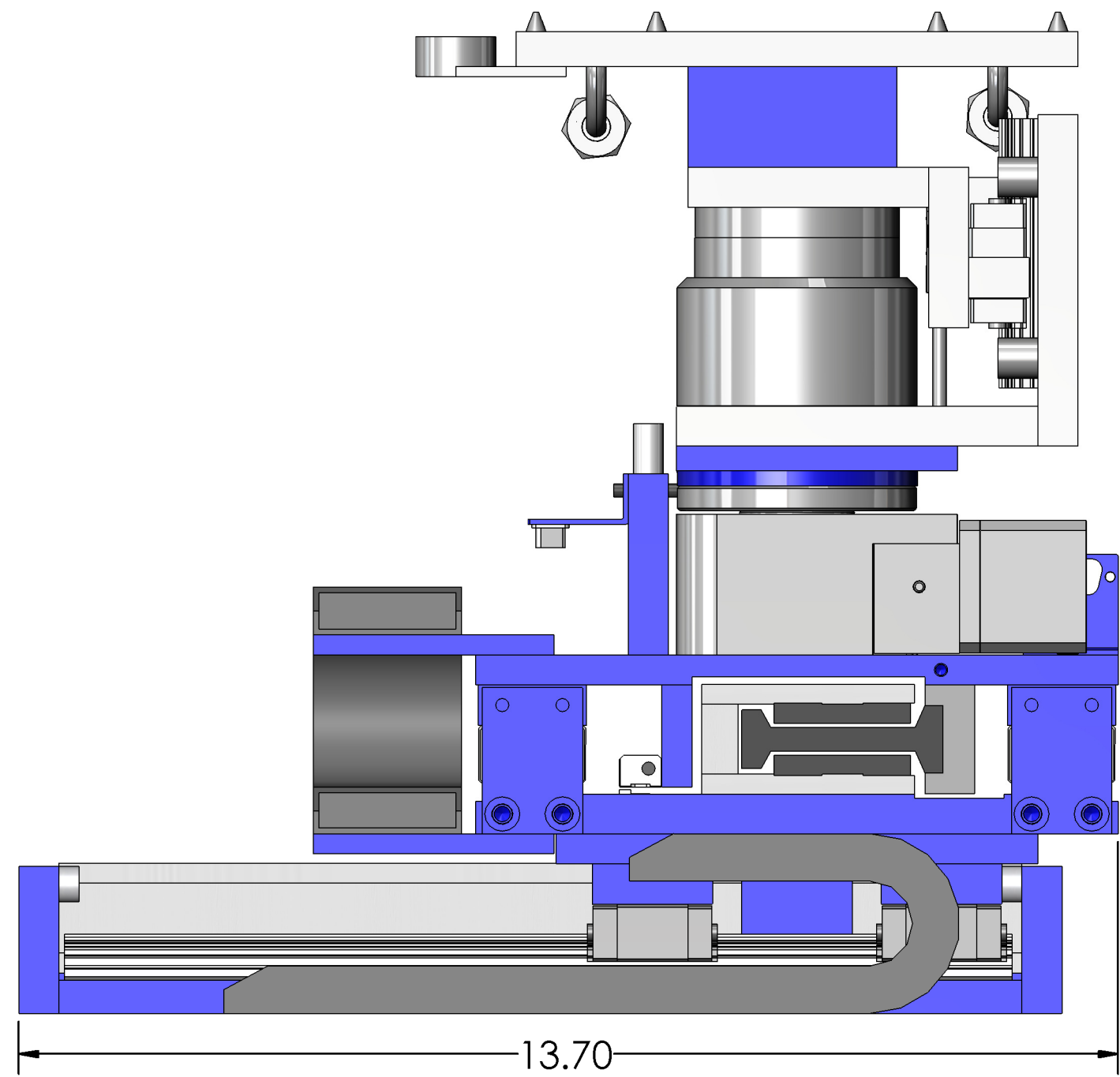

BOTTOM AXIS

- NOTES:
1. Top Axis - Cable carrier will extend about 3in past the edge of the stage when fully extended
 2. Bottom Axis - Cable carrier will extend about 3in past the edge of the stage when fully retracted
 3. System is shown with customer supplied Substrate Holder

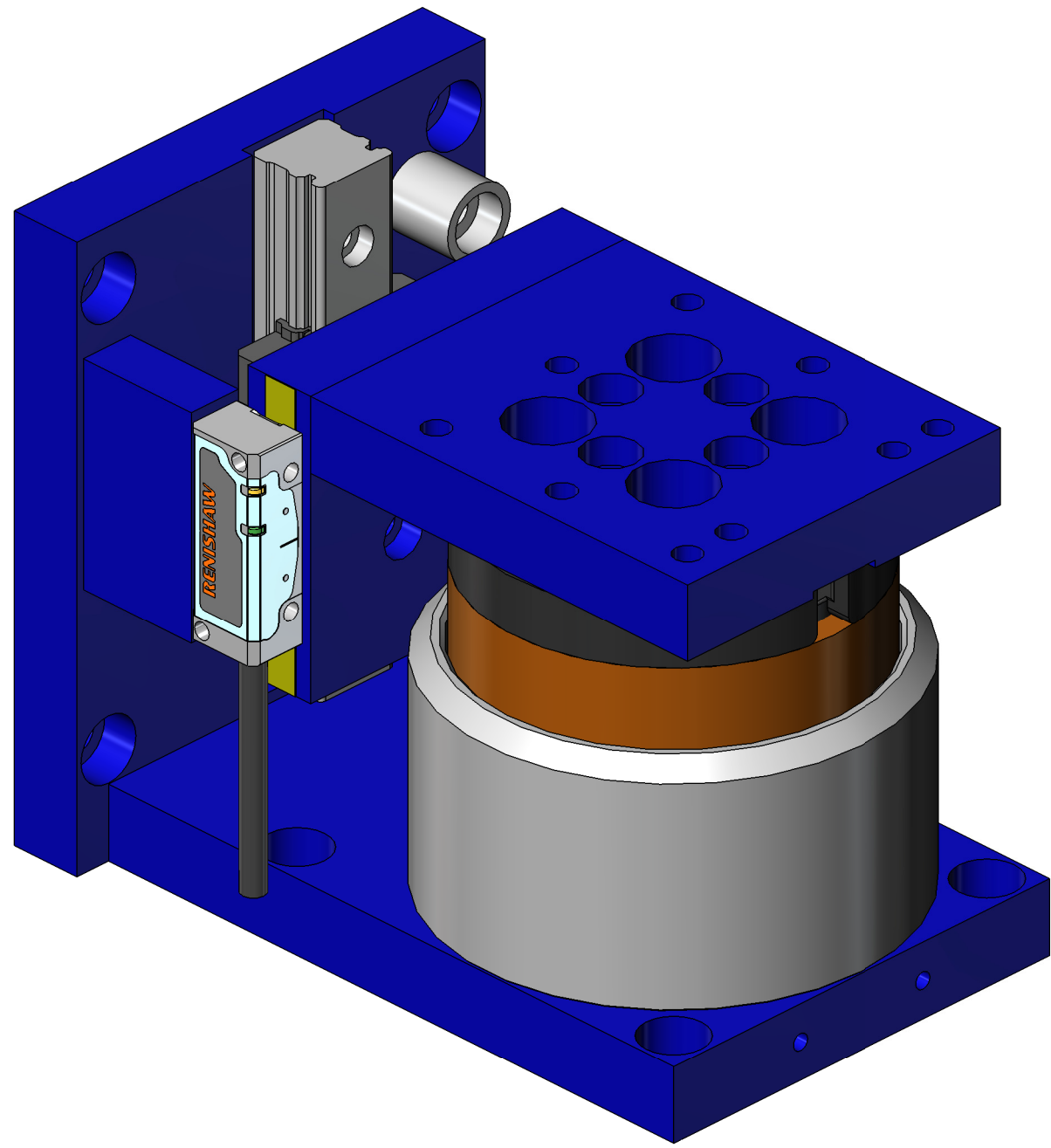

Vertical (Voice Coil Stage)
Stroke = 1.0in
Cont. Force = 10.8lbs
Peak Force = 32.4lbs @ 10% Duty
Encoder = 0.2 micron

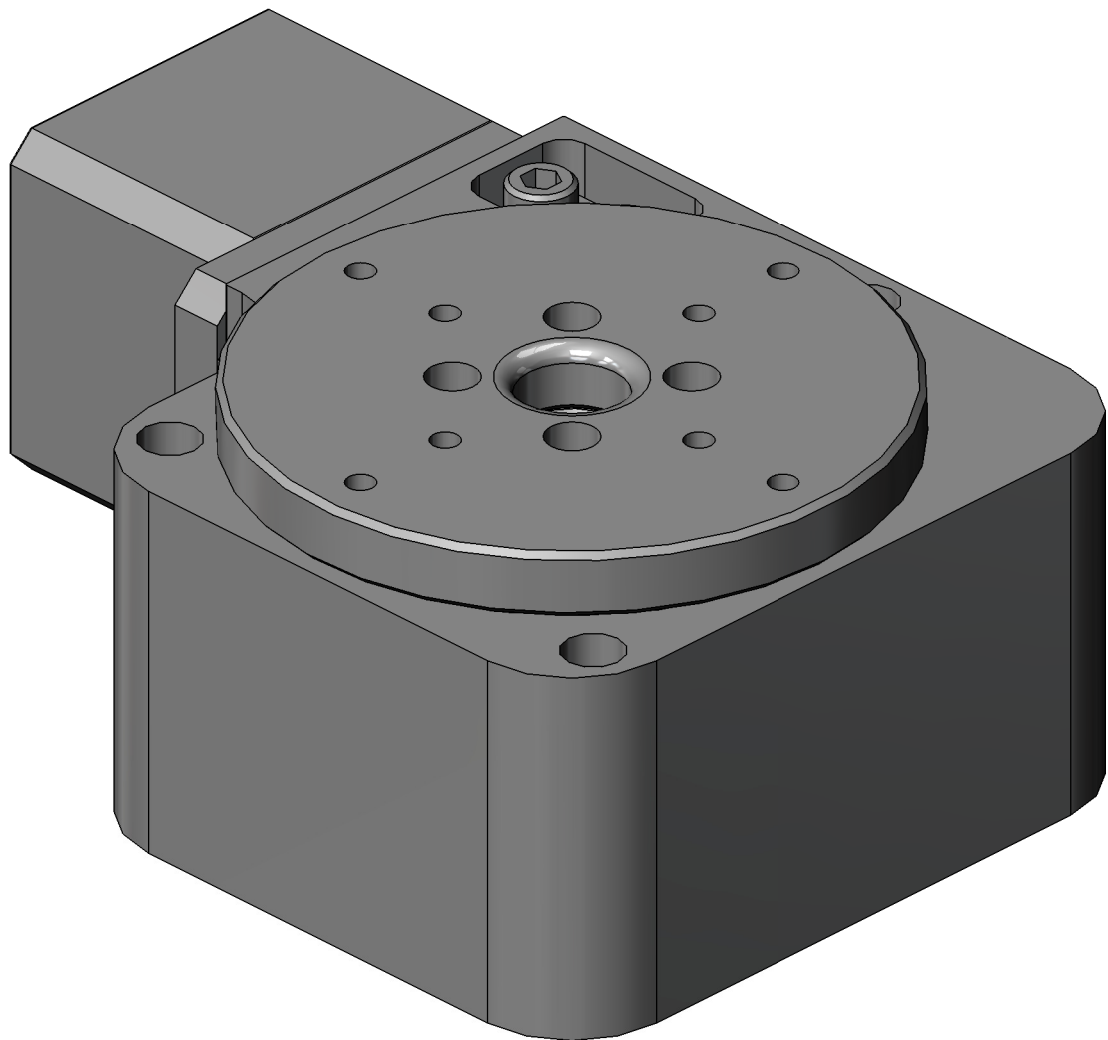

Rotary (Stepper Stage)
Stroke = +/-10°
Encoder = 0.2 micron

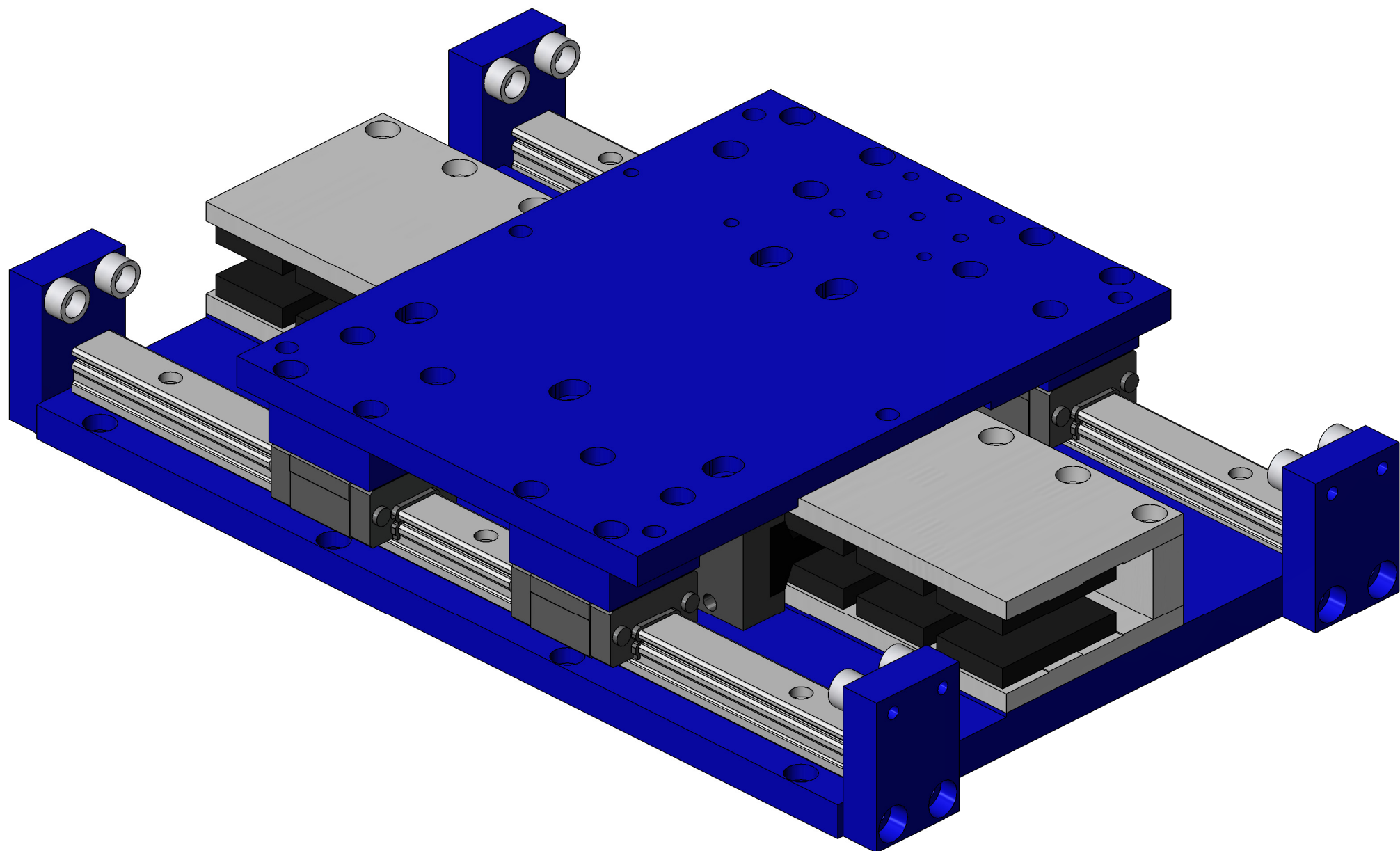

XY Horizontal Axis (Brushless Linear Stage)
Stroke = 6.2in
Cont. Force = 20lbs
Peak Force = 60lbs
Encoder = 0.2 micron