

These drawings and specifications are the property of H2W Technologies, Inc. They are issued in confidence and shall not be reproduced, copied, or used without written permission from H2W Technologies, Inc.

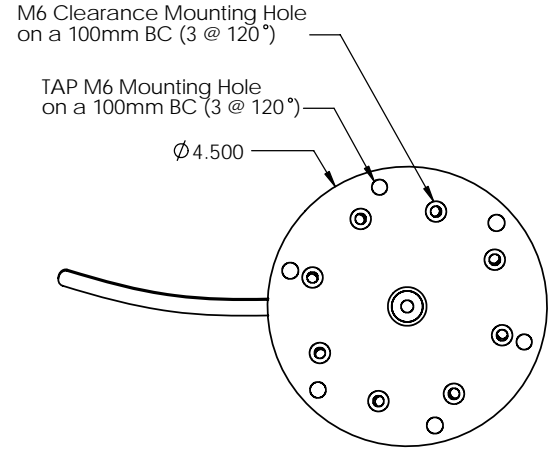
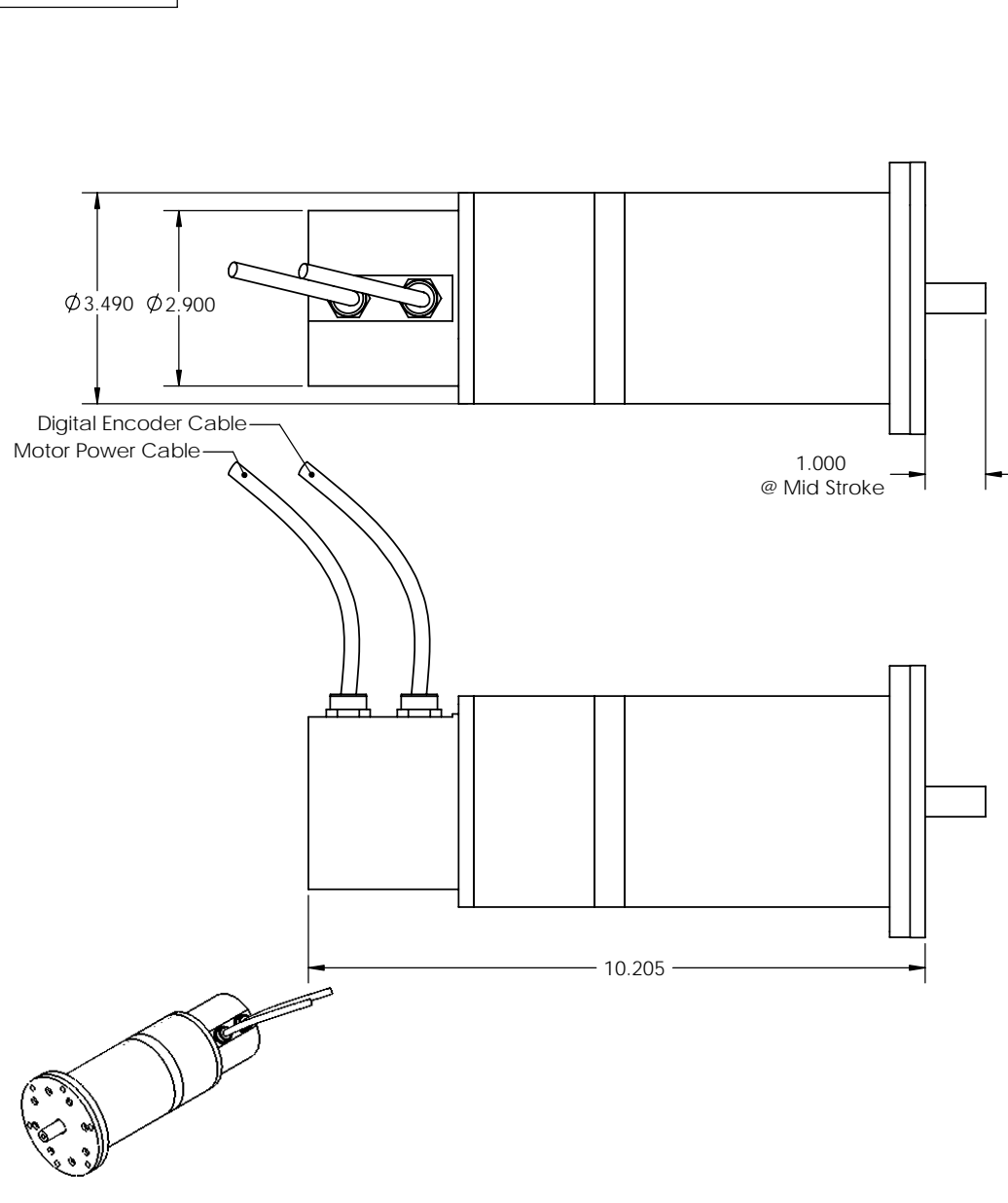

SPECIFICATIONS	
Motor P/N	NCM04-25-250-2LVE
Stroke	0.40"
Bearing Type	Sealed Linear Bushing
Moving Mass	500 grams
Total Mass	2100 grams
Resistance	2.0 ohms
Force Constant	2.88 LBS/(Watt) ^{1/2}
Continuous Force	25.0 LBS
Peak Force	75.0 LBS
Power In @ 100% Duty	75 WATTS

UNLESS SPECIFIED OTHERWISE: All dimensions are in inches. Standard Tolerances are as follows: XXX ±.015 ANGLES .1° XX ±.010 FLEETS AND X ±.020 CORNERS .010 Remove All Burrs and Sharp Edges				RELEASED FOR MFG. DATE 4-26-04 BY <i>Case</i>		H2W Technologies, Inc. 28310-C Ave Crocker Valencia, CA 91355 USA Tel: (661) 702-9346 Fax: (661) 702-9348 www.h2wtech.com	
MATERIAL				FINISH		TITLE	
DRAWN OOG				DATE 3-29-04		APPROVED FGW	
DATE 3-29-04				DATE 3-29-04		DWG # 30-0296	
				REV B		ECN	
						NCM04-26-025-2LVE	