

These drawings and specifications are the property of H2W Technologies, Inc. They are issued in confidence and shall not be reproduced, copied, or used without written permission from H2W Technologies, Inc.

Input Power Leads

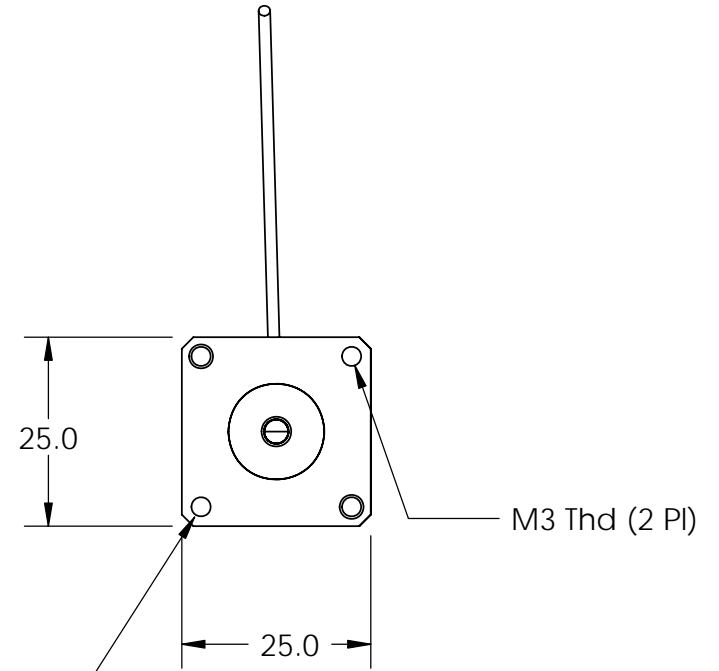

Press fit for an 3.2 M3H7 Dowel Pin (2)

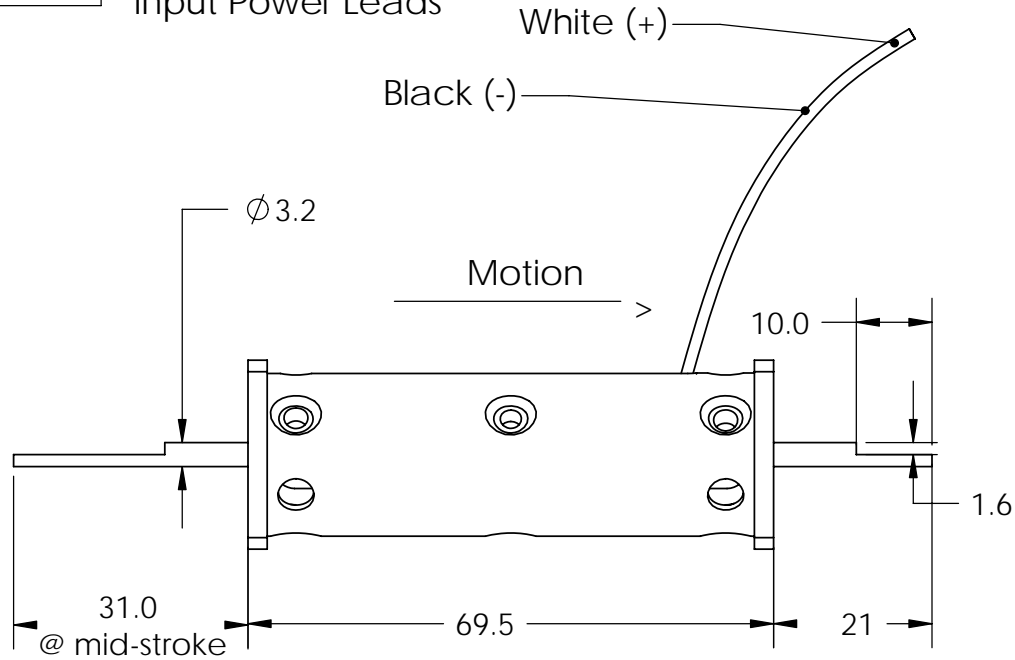
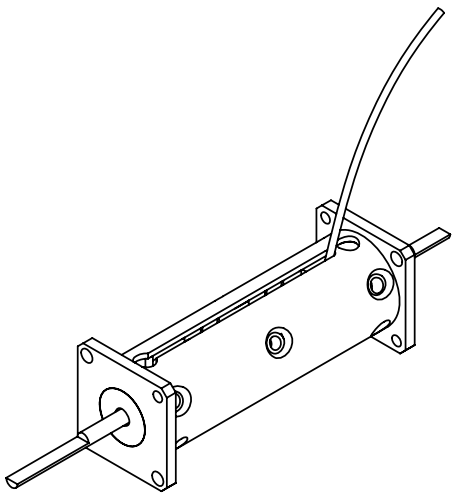

SPECIFICATIONS	
Motor P/N	NCM05-08-005-2JB
Stroke	0.50"
Bearing Type	Jeweled Sapphire
Moving Mass	20 grams
Total Mass	120 grams
Resistance	7.9 ohms
Force Constant	0.30 LBS/(Watt) ^{M/2}
Continuous Force	0.50 LBS
Peak Force	1.50 LBS
Power In @ 100% Duty	3 WATTS

All Dimensions in mm

H2W Technologies, Inc.
28310-C Ave Crocker Valencia, CA 91355 USA
Tel: (661)-702-9346 Fax: (661)-702-9348
www.h2wtech.com

UNLESS SPECIFIED OTHERWISE: All dimensions are in millimeters. Standard Tolerances are as follows .XXX ±.005 ANGLES ±1° .XX ±.010 FILLETS AND .X ±.020 CORNERS .010 Remove All Burrs and Sharp Edges	MATERIAL				TITLE			
	FINISH				NCM05-08-005-2JB			
	DRAWN MPW	DATE 3-14-02	APPROVED FGW	DATE 3-14-02	DWG # 30-0098	REV A	ECN	