

These drawings and specifications are the property of H2W Technologies, Inc. They are issued in confidence and shall not be reproduced, copied, or used without written permission from H2W Technologies, Inc. (www.h2wtech.com)

REVISION TABLE					
REV	ECN#	DESCRIPTION	REV BY	APPROVED	DATE
---	---	Original Drawing	JRM	MPW	06-26-13

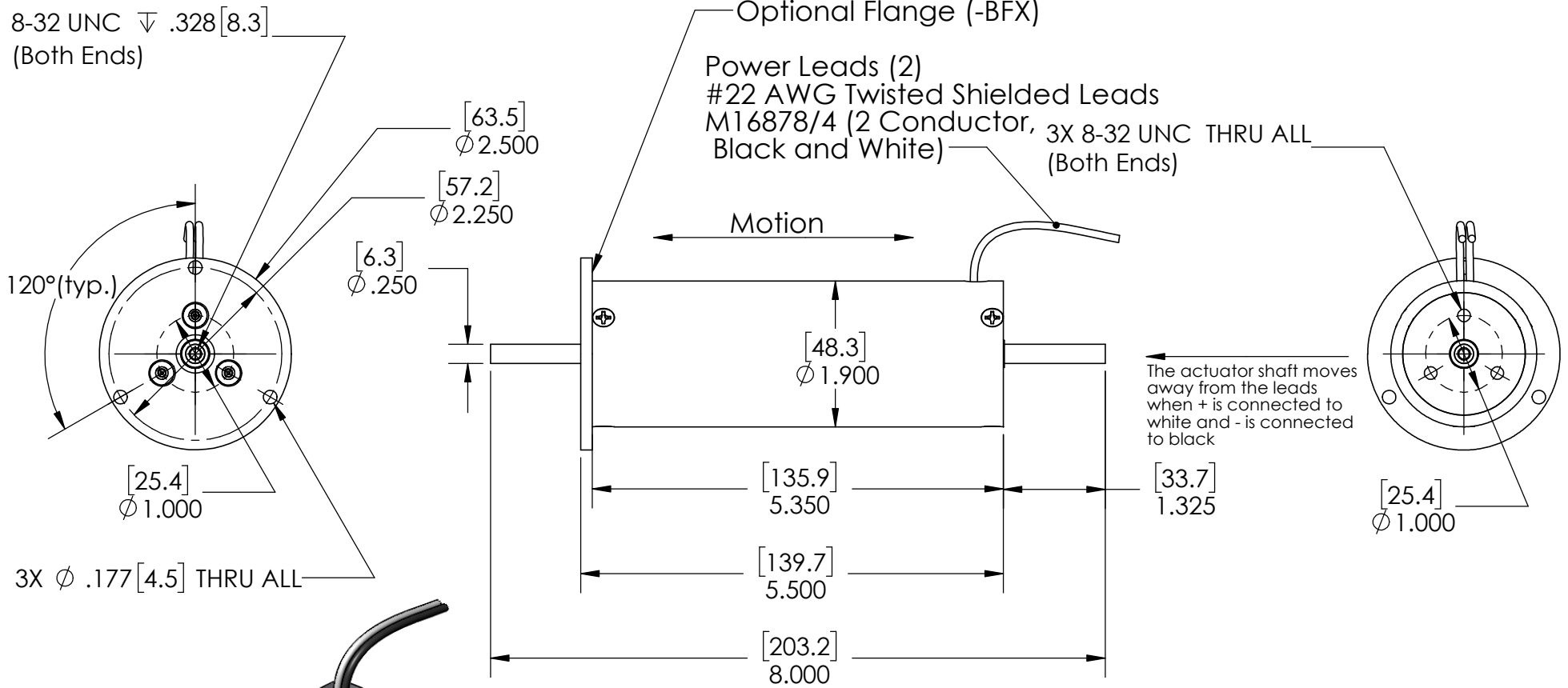

**Actuator shown at midstroke.**

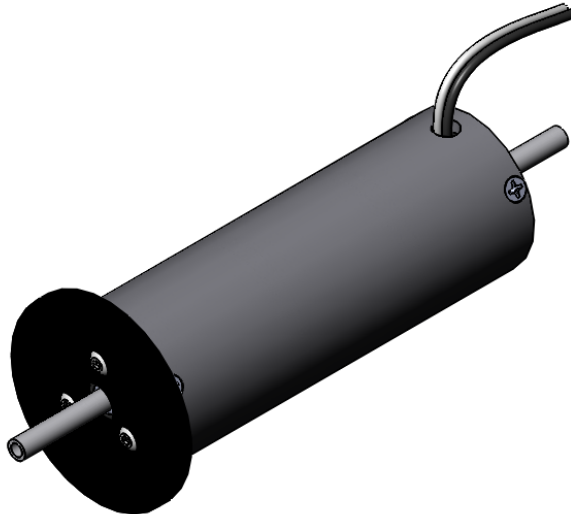

**H2W Technologies, Inc.**  
 26470 Ruether Ave #102 Santa Clarita, CA 91350 USA  
 Tel: (661) 251-2081 Fax: (661) 251-2067  
 www.h2wtech.com

**Model #NCM20-19-050-2BX**

DRAWN		DATE		APPROVED		DATE		DWG #	REV	SHEET
JRM		6-26-13		MPW		6-26-13		<b>30-1125</b>	---	1 of 2

UNLESS SPECIFIED OTHERWISE: All dimensions are in inches Standard Tolerances are as follows .XXX ±.005 ANGLES ±1° .XX ±.010 FILLETS .010 .X ±.020 CORNERS .010 Remove All Burs and Sharp Edges				MATERIAL				TITLE			
				FINISH				Moving Magnet Non-Comm DC Linear Actuator			
								Model #NCM20-19-050-2BX			

<b>MOVING MAGNET NON-COMM ACTUATOR SPECIFICATIONS</b>		
Motor P/N	NCM20-19-050-2BX	
Stroke	2.00"	50.8 mm
Radial Clearance	N/A in	N/A mm
Bearing Type	Nylon Bushings	
Moving Mass	0.67 lbs	305 grams
Total Mass	2.71 lbs	1230 grams
Resistance @ 20C	2.85 ohms	
Inductance @ 20C	1.7 mH	
Electrical Time Constant	0.61 msec	
Motor Constant	1.30 LBS/SQRT(Watt)	5.8 N/SQRT(Watt)
Force Constant	2.0 LBS/Amp	8.9 N/Amp
Back EMF	0.22 V/ips	8.9 V/m/sec
Continuous Force	8.0 LBS	36 N
Max Power @ 100% Duty	48 Watts	
Peak Force	24 LBS	107 N
Max Power @ 10% Duty	343 Watts	

**Note:** The values in the table above are based on models and calculated values, the actual values will be determined at the time of testing, which will be prior to shipment.