

These drawings and specifications are the property of H2W Technologies, Inc. They are issued in confidence and shall not be reproduced, copied, or used without written permission from H2W Technologies, Inc. (www.h2wtech.com)

REVISION TABLE					
REV	ECN#	DESCRIPTION	REV BY	APPROVED	DATE
---	---	Original Drawing	SDC	MPW	7-8-15

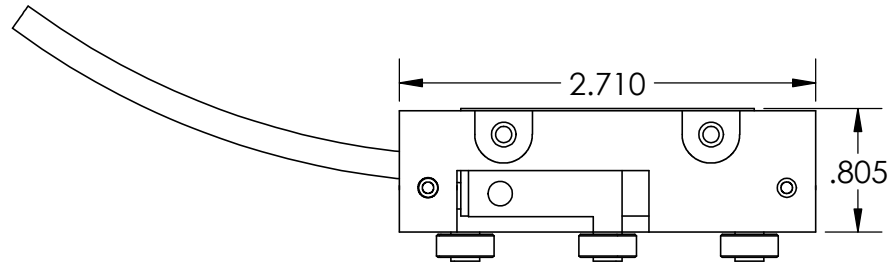
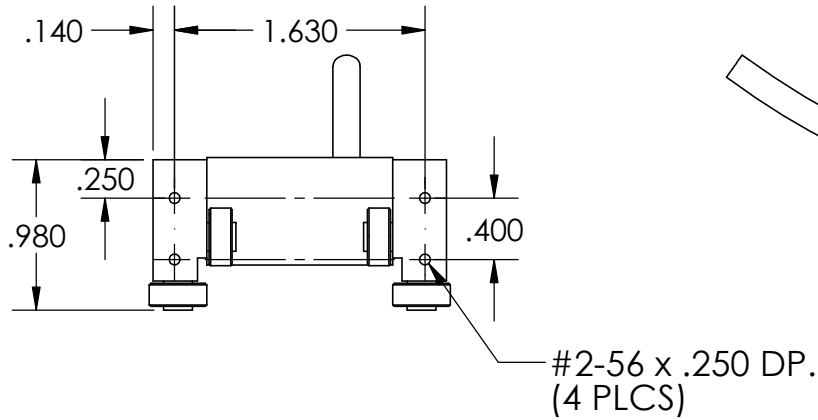
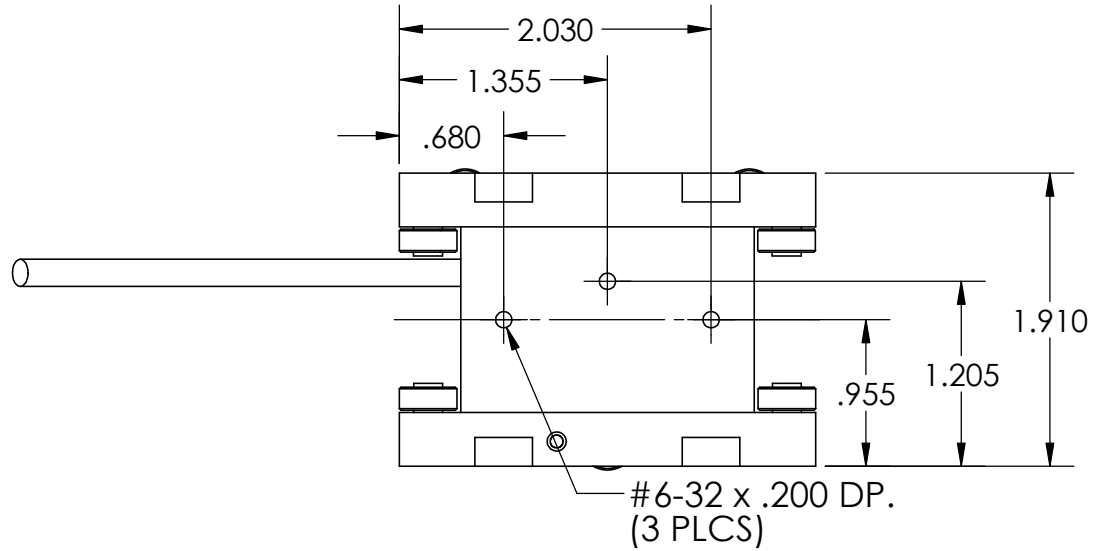

Motor Power Cable

Lead Color	Function
Yellow	A+
White	A-
Red	B+
Black	B-

10in Long  
(standard length)

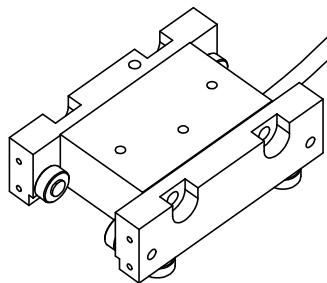

UNLESS SPECIFIED OTHERWISE:  
All dimensions are in inches  
Standard Tolerances are as follows  
.XXX ±.005 ANGLES ±1°  
.XX ±.010 FILLETS .010  
.X ±.020 CORNERS .010  
Remove All Burs and Sharp Edges

MATERIAL			
FINISH			
DRAWN	DATE	APPROVED	DATE
SDC	7-8-15	MPW	7-8-15

**Forcer Model #LMSS0602-2WW0**



**H2W Technologies, Inc.**  
26380 Ferry Court Santa Clarita, CA 91350 USA  
Tel: (661) 291-1620 Fax: (661) 291-1626  
www.h2wtech.com

TITLE			
2lb Linear Stepper Motor			
DWG #	REV	SHEET	
<b>10-0610</b>	---	1 of 4	

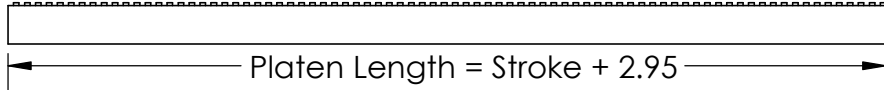
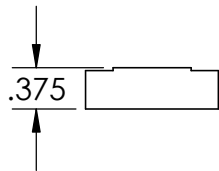
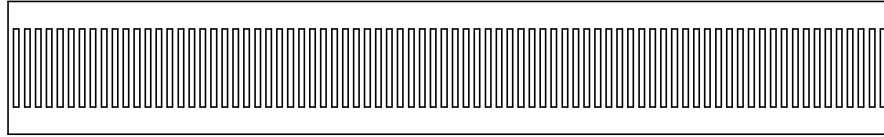

#8-32 x .200 DP.  
(4 PLCS)

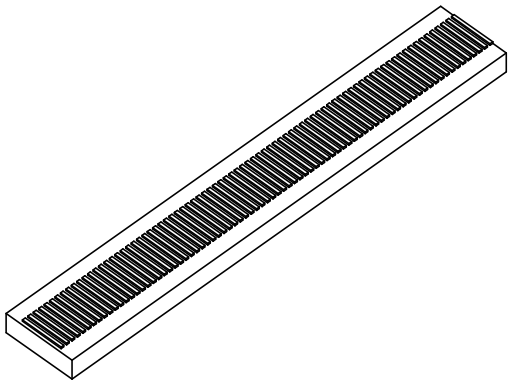
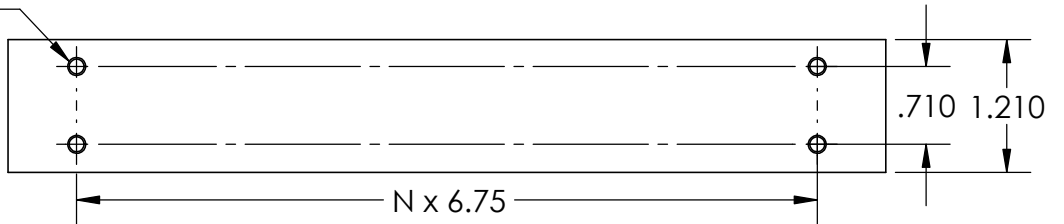

**Platen Model # STP-20-XXX-R**

TITLE	<b>2lb Linear Stepper Motor</b>		
DWG #	<b>10-0610</b>	REV	---
		SHEET	2 of 4

XXX = Platen Length in inches

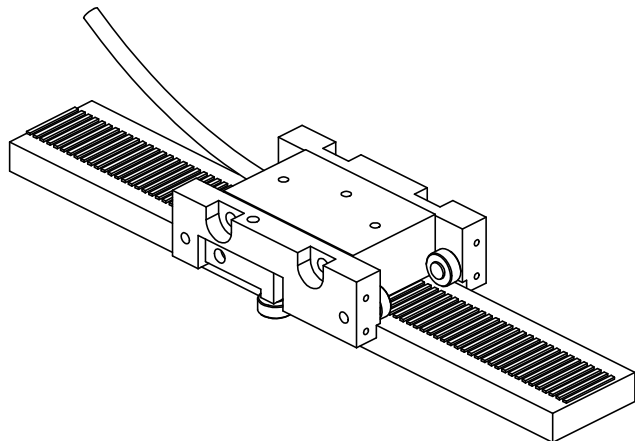
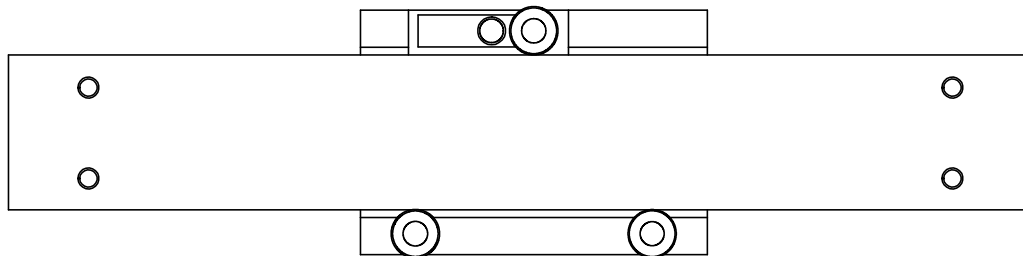
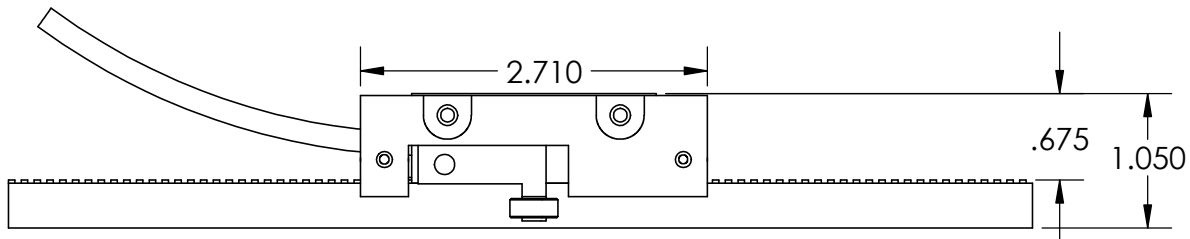
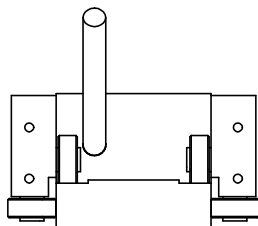
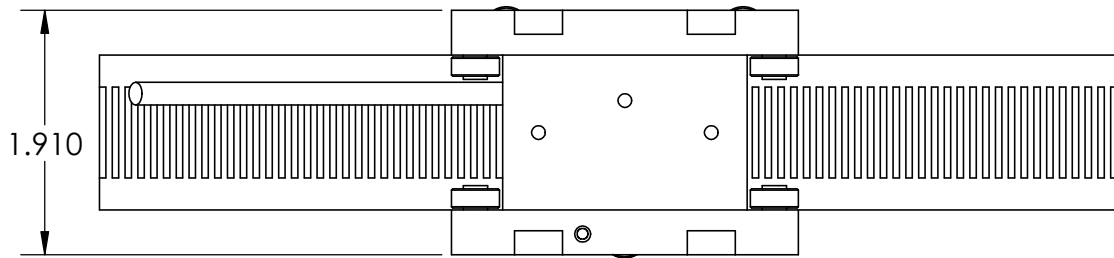

**Forcer Mounted on Platen**

TITLE	<b>2lb Linear Stepper Motor</b>		
DWG #	<b>10-0610</b>	REV	---
		SHEET	3 of 4

## LINEAR STEPPER MOTOR SPECIFICATIONS

Motor P/N	LMSS0602-2WW0	
Continuous Force	1.0 LBS	4.5 N
Rated Current	1.5 Amp	
Resistance/Phase @ 20C	1.5 ohms	
Inductance/Phase @ 20C	1.2 mH	
Motor Phases	2	
Bearing Type	Roller Bearing	
Nominal Airgap	0.0015"	
Motor Mass	6.4 oz	181 grams

TITLE	<b>2lb Linear Stepper Motor</b>		
DWG #	<b>10-0610</b>	REV	---
		SHEET	4 of 4