

These drawings and specifications are the property of H2W Technologies, Inc. They are issued in confidence and shall not be reproduced, copied, or used without written permission from H2W Technologies, Inc.

| REVISION TABLE | | | | | |
|----------------|------|------------------|--------|----------|---------|
| REV | ECN# | DESCRIPTION | REV BY | APPROVED | DATE |
| --- | --- | Original Drawing | OOG | MPW | 9-10-13 |

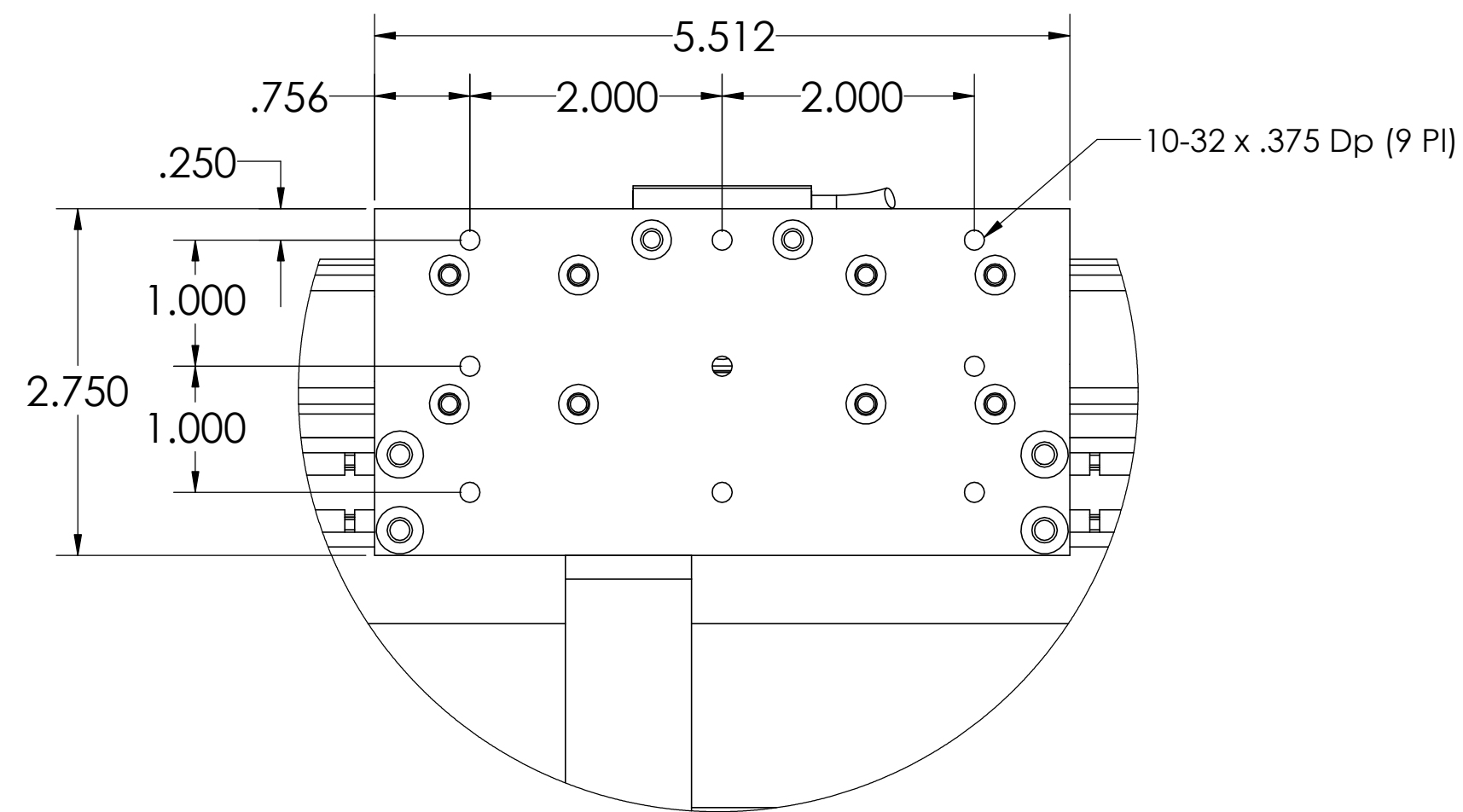

DETAIL A

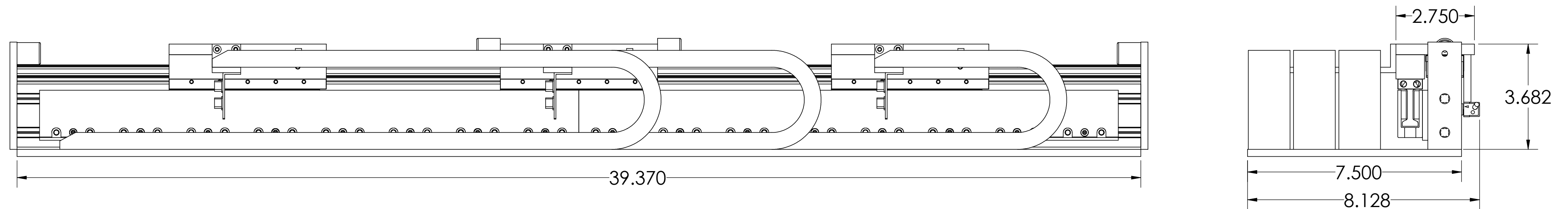
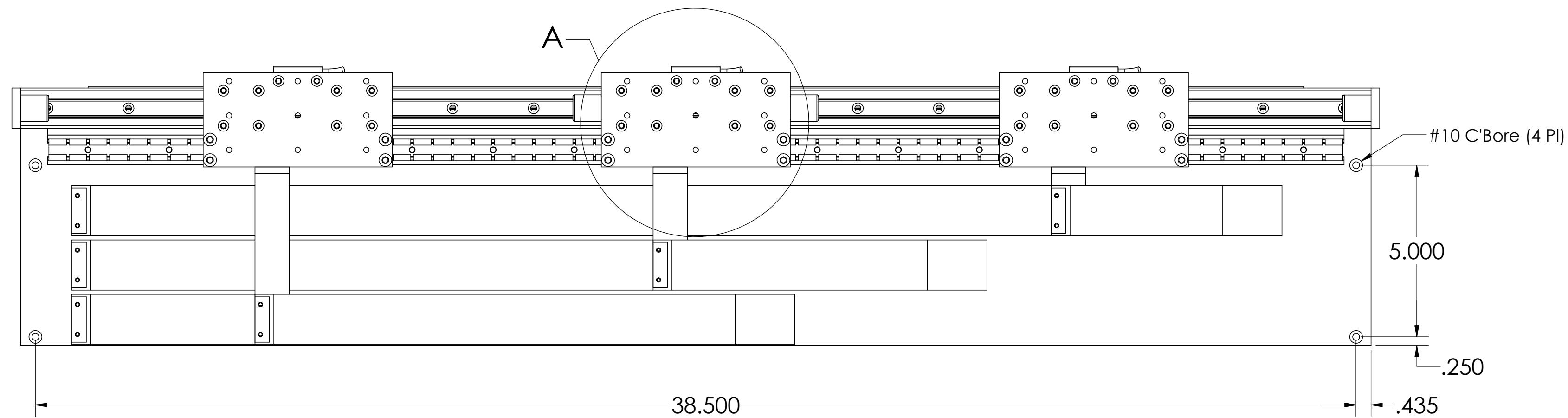

H2W Technologies, Inc.
26470 Ruether Ave #102 Santa Clarita, CA 91350 USA
Tel: (661) 251-2081 Fax: (661) 251-2067
www.h2wtech.com

| | | | | | | | |
|---|-----------------|-----------------|-----------------|---|------------|-----------------|--|
| UNLESS SPECIFIED OTHERWISE: All dimensions are in inches Standard Tolerances are as follows XXX ±.005 ANGLES ±1° .XX ±.010 FILLETS AND .XX ±.020 CORNERS 0.0 Remove All Burrs and Sharp Edges | | MATERIAL | | TITLE Single Rail Positioning Stage Model #: SRS-020-08-13-01-3EX | | | |
| | | FINISH | | | | | |
| DRAWN OOC | DATE 9.10.13 | APPROVED MPW | DATE 9.10.13 | DWG # 40-0260 | REV --- | SHEET 1 of 3 | |

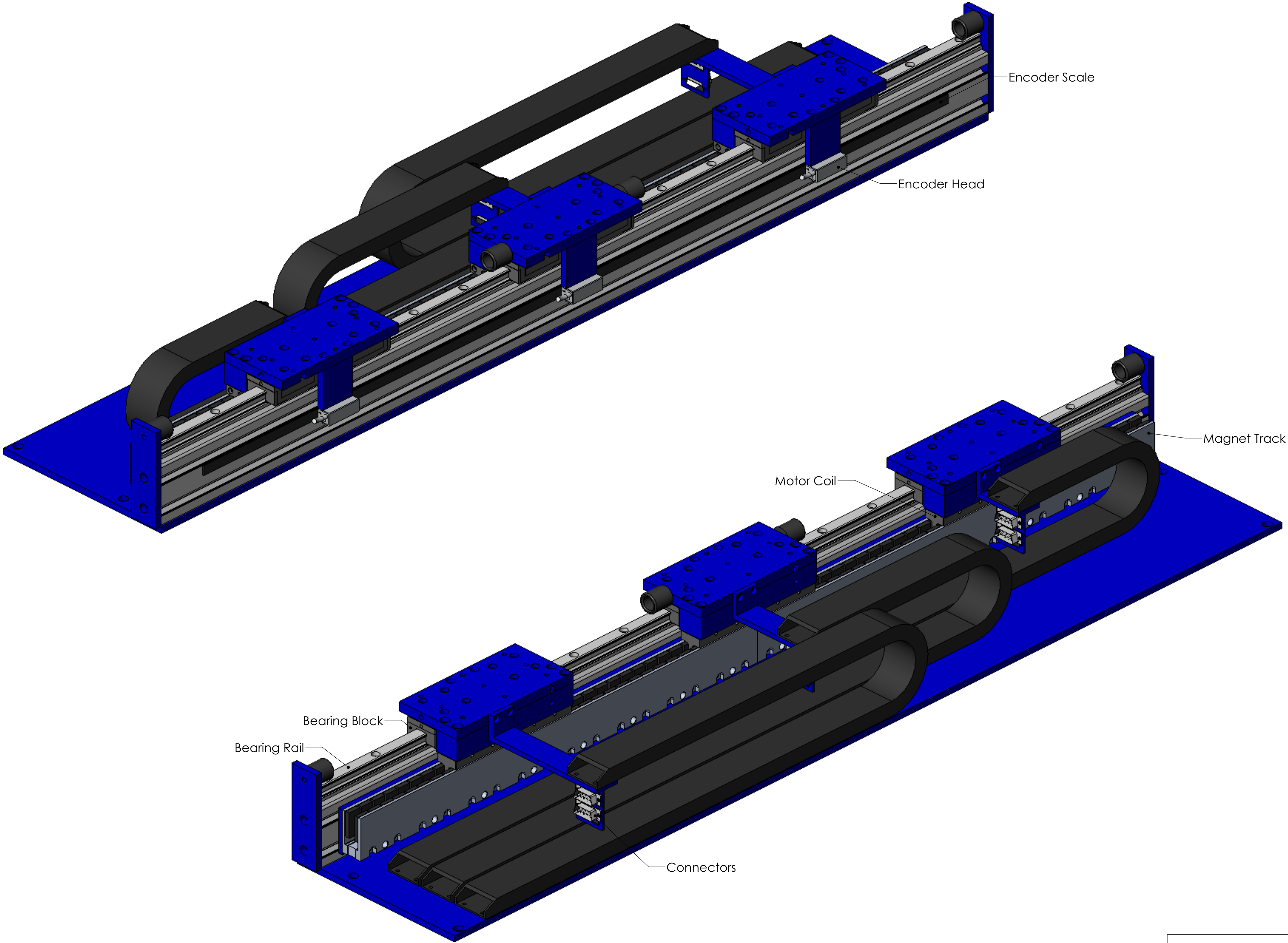

| SINGLE RAIL POSITIONING STAGE SPECIFICATIONS | | |
|--|---------------------|------------------|
| Motor P/N | BLD-PA4 | |
| Stroke | 20 in | 508 mm |
| Encoder Resolution | 1 micron | |
| Bearing Type | Recirculating Ball | |
| Moving Mass | 2.75 lbs | 1.25 kg |
| Total Mass | 38 lbs | 17.23 kg |
| Resistance @ 20C | 29.2 ohms | |
| Inductance @ 20C | 5.0 mH | |
| Electrical Time Constant | 0.17 msec | |
| Motor Constant | 1.50 LBS/SQRT(Watt) | 6.6 N/SQRT(Watt) |
| Force Constant | 8.1 LBS/Amp | 36.0 N/Amp |
| Back EMF | 0.75 V/ips | 29.2 V/m/sec |
| Force @ 100% Duty | 13.0 lbs | 57.6 N |
| Power @ 100% Duty | 74.8 watts | |
| Current @ 100% Duty | 1.6 amps | |
| Force @ 10% Duty | 52.0 lbs | 230.4 N |
| Power @ 10% Duty | 1196 watts | |
| Current @ 10% Duty | 6.4 amps | |
| Stage Length | 39.37 in | 1000 mm |
| Stage Width | 5.12 in | 130.3 mm |
| Stage Height | 3.68 in | 93.47 mm |

NOTES:
- Motor Specs are per individual moving coil (table)
- Moving Mass is per individual moving coil (table)
- Total Mass is for entire assembly